

**TECHNICAL MANUAL**  
**GENERAL SUPPORT MAINTENANCE REPAIR**  
**PARTS AND**  
**SPECIAL TOOLS LIST**  
**(INCLUDING DEPOT MAINTENANCE REPAIR**  
**PARTS AND SPECIAL TOOLS)**  
**FOR**  
**TEST SET, RADIO AN/ARM-63**  
**(NSN 6625-00-868-8323)**

---

**HEADQUARTERS, DEPARTMENT OF THE ARMY**

**FEBRUARY 1977**



TECHNICAL MANUAL  
 No. 11-6625-556-40P



HEADQUARTERS  
 DEPARTMENT OF THE ARMY  
 WASHINGTON, DC, 8 February 1977

**GENERAL SUPPORT MAINTENANCE REPAIR PARTS  
 AND SPECIAL TOOLS LISTS  
 (INCLUDING DEPOT MAINTENANCE REPAIR PARTS  
 AND SPECIAL TOOLS)  
 FOR  
 T10EST SET, RADIO AN/ARM-63  
 (NSN 6625-00-868-8323)**

Current as of 10 October 1976

**REPORTING OF ERRORS**

You can improve this manual by recommending improvements using DA Form 2028-2 (Test) located in the back of the manual. Simply tear out the self-addressed form, fill it out as shown on the sample, fold it where shown, and drop it in the mail.

If there are no blank DA Form 2028-2 (Test) in the back of your manual, use the standard DA Form 2028 (Recommended Changes to Publications and Blank Forms) and forward to the Commander, US Army Electronics Command, ATTN: DRSEL-MA-Q, Fort Monmouth, New Jersey 07703.

In either case a reply will be furnished direct to you.

**Table of Contents**

SECTION		Page	Illustration Figure
	I Introduction . . . . .	1	
	II Repair parts list . . . . .	5	
Group	00 Test Set, Radio AN/ARM-63 (ARC Model BTK-35A) . . . . .	5	1
	01 Test Set, Radio TS-1797/ARM-63 . . . . .	7	2,3
	0101 Control Unit, Course C-1827/ARC-55 . . . . .	15	4
	010101 Switch assembly . . . . .	17	5
	0102 Control, receiver . . . . .	19	6
	0103 Indicator, Course ID-453/ARN-30 . . . . .	21	7
	0104 Indicator, Course ID-250A/ARN (No authorized) . . . . .	23	8
	0105 Cable assembly, special purpose . . . . .	25	9
	0106 Cable assembly . . . . .	27	10
	0107 Rear panel assembly . . . . .	29	11
	0108 Cable assembly . . . . .	31	12
	02 Simulator, Antenna Position SM-295/ARM 0201 Box assembly, coupling (No-parts authorized) . . . . .	33	13
	03 Box, Interconnecting J-1107/ARN . . . . .	36	14
	04 Cable Assembly, Power CX43739/ARM-63 . . . . .	37	15
	05 Wiring Harness, Branched CX-8749/ARM-63 . . . . .	39	16
	06 Wiring harness, branched(W2) . . . . .	41	17
	07 Wiring harness, branched (W3) . . . . .	43	18
	08 Wiring harness, branched (W4) . . . . .	45	19
Group	09 Cable assembly (W5) . . . . .	45	19

This manual supersedes so much of TM 11-6625-656-46, 14 September 1986, including Change 1, 27 September 1967, as pertains to repair parts and special tools lists.

**Table of Contents-Continued**

	<i>Page</i>	<i>Illustration Figure</i>
10 Wiring harness, branched (W6).....	47	20
11 Tip plug assembly.....	49	21
12 Wiring harness, branched (W7).....	51	22
13 Wiring harness, branched (W8).....	53	23
14 Cable assembly (W9).....	55	24
15 Cable assembly (WH10).....	57	25
16 Cable assembly (W11).....	59	26
17 Cable assembly (W12).....	61	27
18 Cable assembly (W13).....	63	28
19 Cable assembly, radio frequency (W14).....	65	29
20 Cable assembly (W15).....	67	30
SECTION III. Special tools list( Not applicable)		
IV. National stock number and part number index . . . . .	68	

## SECTION I

### INTRODUCTION

#### 1. Scope

This manual lists repair parts and special tools required for performance of general support maintenance of the AN/ARM-63.

#### 2. General

This Repair Parts and Special Tools List is divided into the following sections:

*a. Section II. Repair Parts List.* A list of repair parts authorized for use in the performance of maintenance. The list also includes parts which must be removed for replacement of the authorized parts. Parts lists are composed of functional groups in ascending numerical sequence, with the parts in each group listed in figure and item number sequence.

*b. Section III. Special Tools List.* Not applicable.

*c. Section IV. National Stock Number and Part Number Index.* A list, in ascending National item identification number (NIIN, last 9 digits) sequence, of all National stock numbers appearing in the listings, followed by a list, in alphameric sequence, of all part numbers appearing in the listings. National stock number and part numbers are cross-referenced to each illustration figure and item number appearance.

#### 3. Explanation of Columns

The following provides an explanation of columns found in the tabular listings:

*a. Illustration.* This column is divided as follows:

(1) *Figure number.* Indicates the figure number of the illustration in which the item is shown.

(2) *Item number.* The number used to identify each item called out in the illustration.

*b. Source, Maintenance, and Recoverability Codes (SMR).*

(1) *Source code.* Source codes are assigned to support items to indicate the manner of acquiring support items for maintenance, repair, or overhaul of end items. Source codes are entered in the first, and second positions of the Uniform SMR Code format as follows:

Code	Definition
------	------------

PA	Item procured and stocked for anticipated or known usage.
----	---

XD-A	support item that is not stocked. When required, item will be procured through normal supply channels.
------	--

#### NOTE

Cannibalization or salvage may be used as a source of supply for any items source coded above except those coded XA, XD, and aircraft support items as restricted by AR 700-42.

(2) *Maintenance code.* Maintenance codes are assigned to indicate the levels of maintenance authorized to USE and REPAIR support items. The maintenance codes are entered in the third and fourth positions of the Uniform SMR Code format as follows:

(a) The maintenance code entered in the third position will indicate the lowest maintenance level authorized to remove, replace, and use the support item. The maintenance code entered in the third position will indicate one of the following levels of maintenance:

Code	Application/Explanation
O-	Support item is removed, replaced, used at the organizational level.
H-	Support item is removed, replaced, used at the general support level.

(b) The maintenance code entered in the fourth position indicates whether the item is to be repaired and identifies the lowest maintenance level with the capability to perform complete repair (i. e., all authorized maintenance functions). This position will contain one of the following maintenance codes:

Code	Application/Explanation
H	The lowest maintenance level capable of complete repair of the support item is the general support level.
Z-	Nonreparable. No repair is authorized.

(3) *Recoverability code.* Recoverability codes are assigned to support items to indicate the disposition action on unserviceable items. The recoverability code is entered in the fifth position of the Uniform SMR Code format as follow:

Recoverability codes	Definition
Z-	Nonreparable item. When unserviceable, condemn and dispose at the level indicated in position 3.
H	Repairable item. When uneconomically repairable, condemn and dispose at the general support level.

*c. National Stock Number.* Indicates the

National stock number assigned to the item and will be used for requisitioning purposes.

*d. Part Number.* Indicates the primary number used by the manufacturer (individual, company, firm, corporation, or Government activity), which controls the design and characteristics of the item by means of its engineering drawings, specifications standards, and inspection requirements, to identify an item or range of items.

#### NOTE

When a stock numbered item is requisitioned, the repair part received may have a different part number than the part being replaced.

*e. Federal Supply Code for Manufacturer (FSCM).* The FSCM is a 5-digit numeric code listed in SB 708-42 which is used to identify the manufacturer, distributor, or Government agency, etc.

*f. Description.* Indicates the Federal item name and, if required, a minimum description to identify the item.

*g. Unit of Measure (U/M).* Indicates the standard of the basic quantity of the listed item as used in performing the actual maintenance function. This measure is expressed by a two-character alphabetical abbreviation (e.g., ea, in, pr, etc.). When the unit of measure differs from the unit of issue, the lowest unit of issue that will satisfy the required units of 'measure will be requisitioned.

*h. Quantity Incorporated in Unit.* Indicates the quantity of the item used in the breakout shown on the illustration figure, which is prepared for a functional group, subfunctional group, or an assembly.

#### 4. Special Information

The following publications pertain to the AN/ARM-63 and its components:

TM 11-6625-556-12, Test Set, Radio AN/ARM-63 (Aircraft Radio Corp Model BTK-35A)

TM 11-6625-556-45, Test Set, Radio AN/ARM-63 (Aircraft Radio Corp Model BTK-35A)

#### 5. How to Locate Repair Parts

*a.* When National stock number or part number is unknown.

(1) *First.* Using the table of contents, determine the functional group within which the repair part belongs. This is necessary since illustrations are prepared for functional groups and listings are divided into the same groups.

(2) *Second.* Find the illustration covering the functional group to which the repair part belongs.

(3) *Third.* Identify the repair part on the illustration and note the illustration figure and item number of the repair part.

(4) *Fourth.* Using the Repair Parts Listing, find the figure and item number noted on the illustration.

*b.* When National stock number or part is known.

(1) *First.* Using the Index of National Stock Numbers and Part Numbers, find the pertinent National stock number or part number. This index is in ascending NIIN sequence followed by a list of part numbers in ascending alphameric sequence, cross-referenced to the illustration figure number and item number.

(2) *Second.* After finding the figure and item number, locate the figure and item number in the repair parts list.

#### 6. Abbreviations

Not applicable.

(Next printed page is 4)



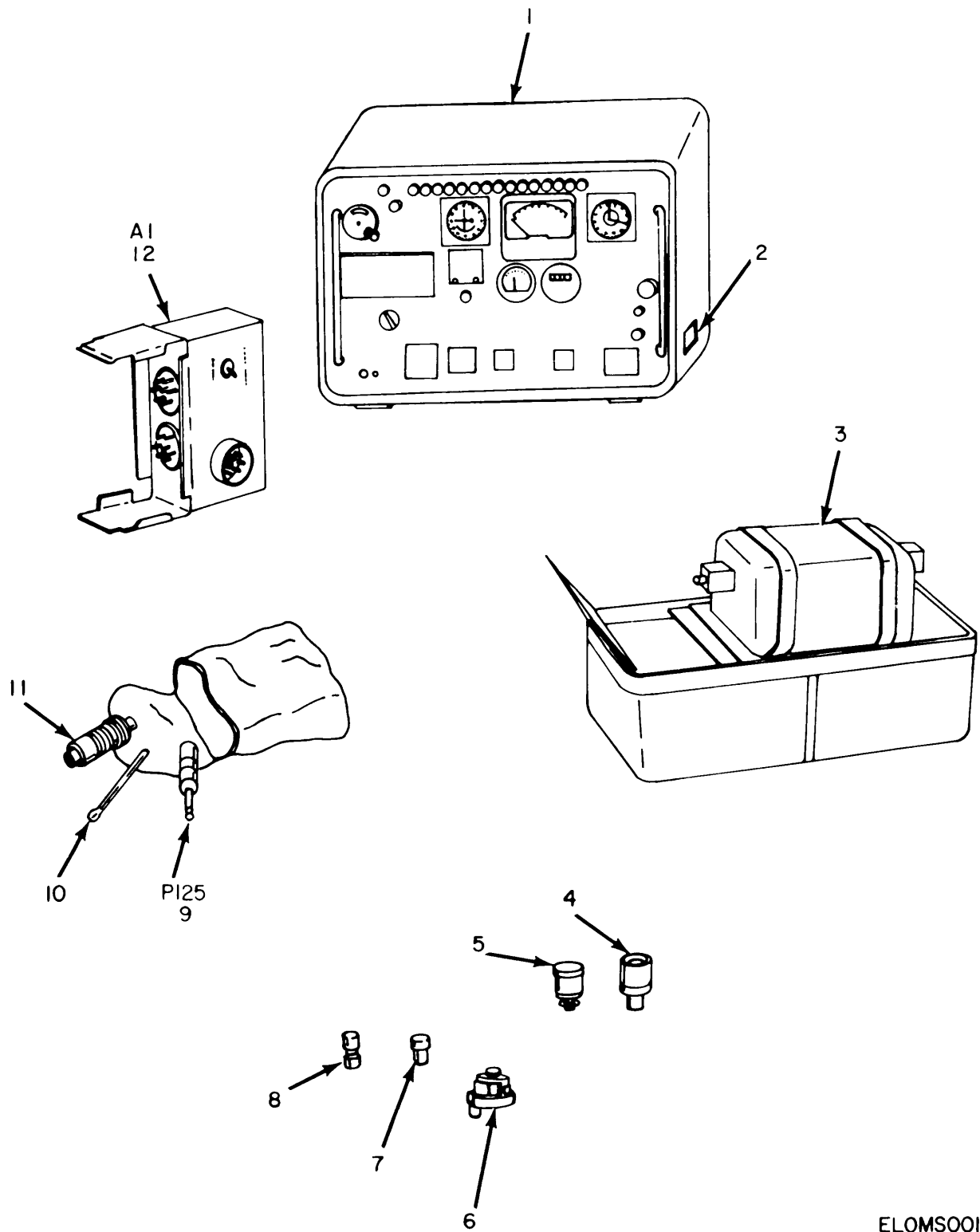

ELOMS001

Figure 1. Test Set, Radio AN/ARM-63 (ARC Model BTK-35A)  
(Sheet 1 of 3).



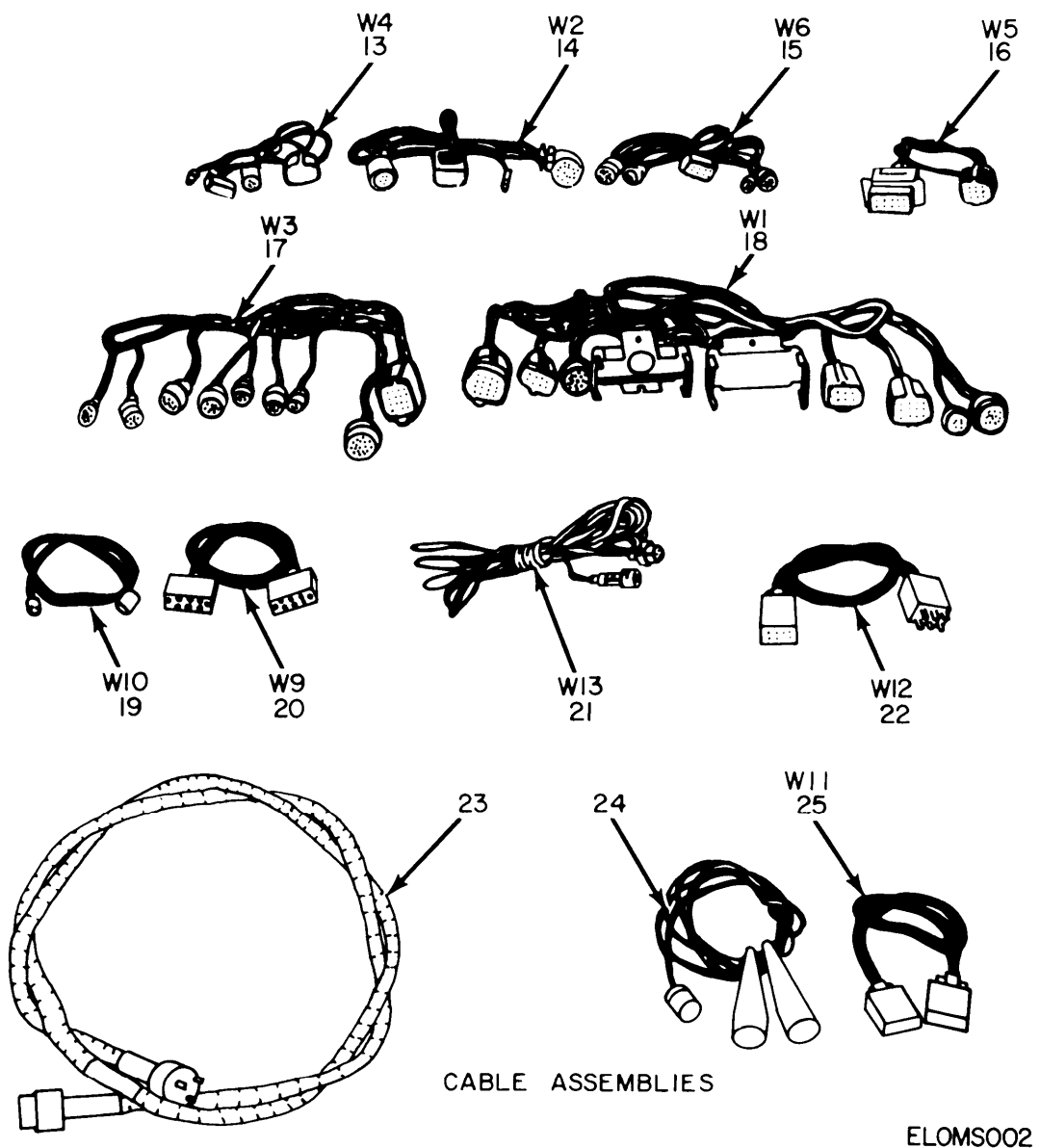

Figure 1. Test Set, Radio AN/ARM-63 (ARC Model BTK-35A)  
(Sheet 2 of 3).

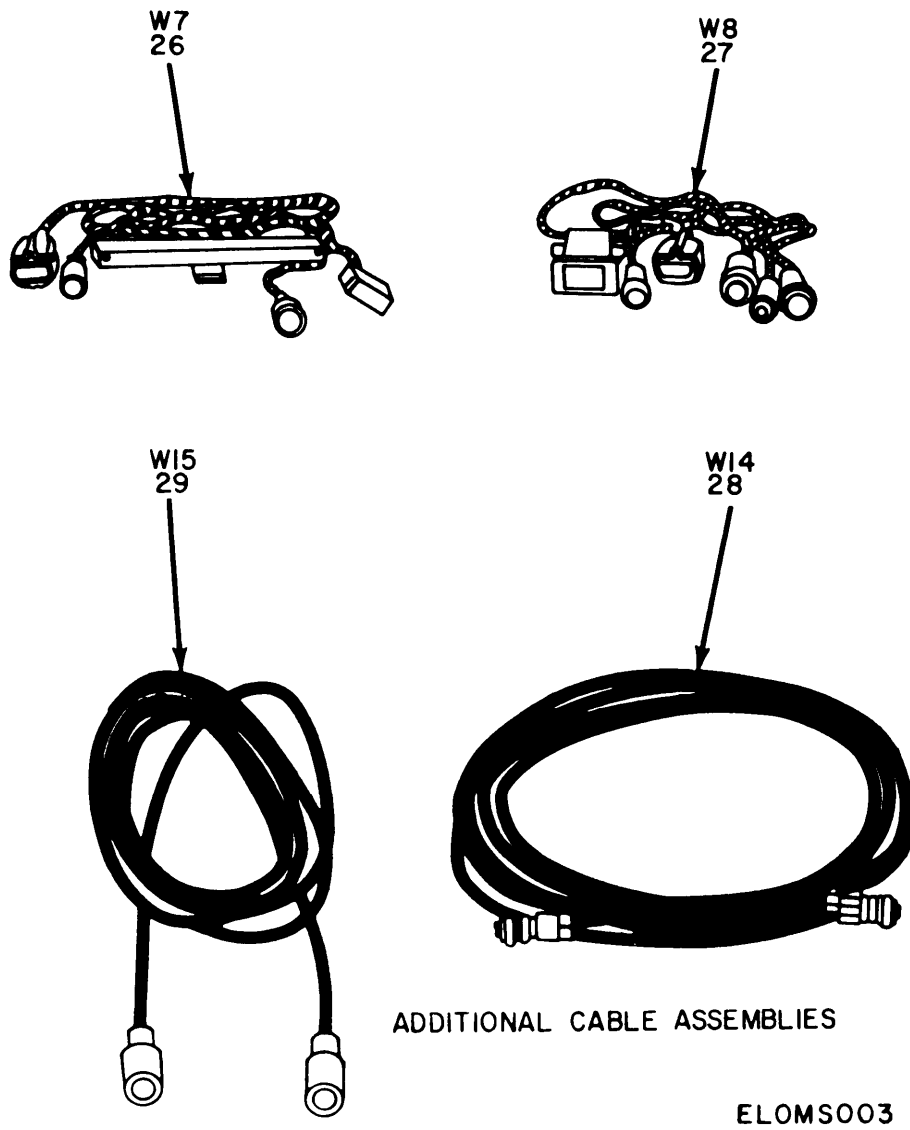
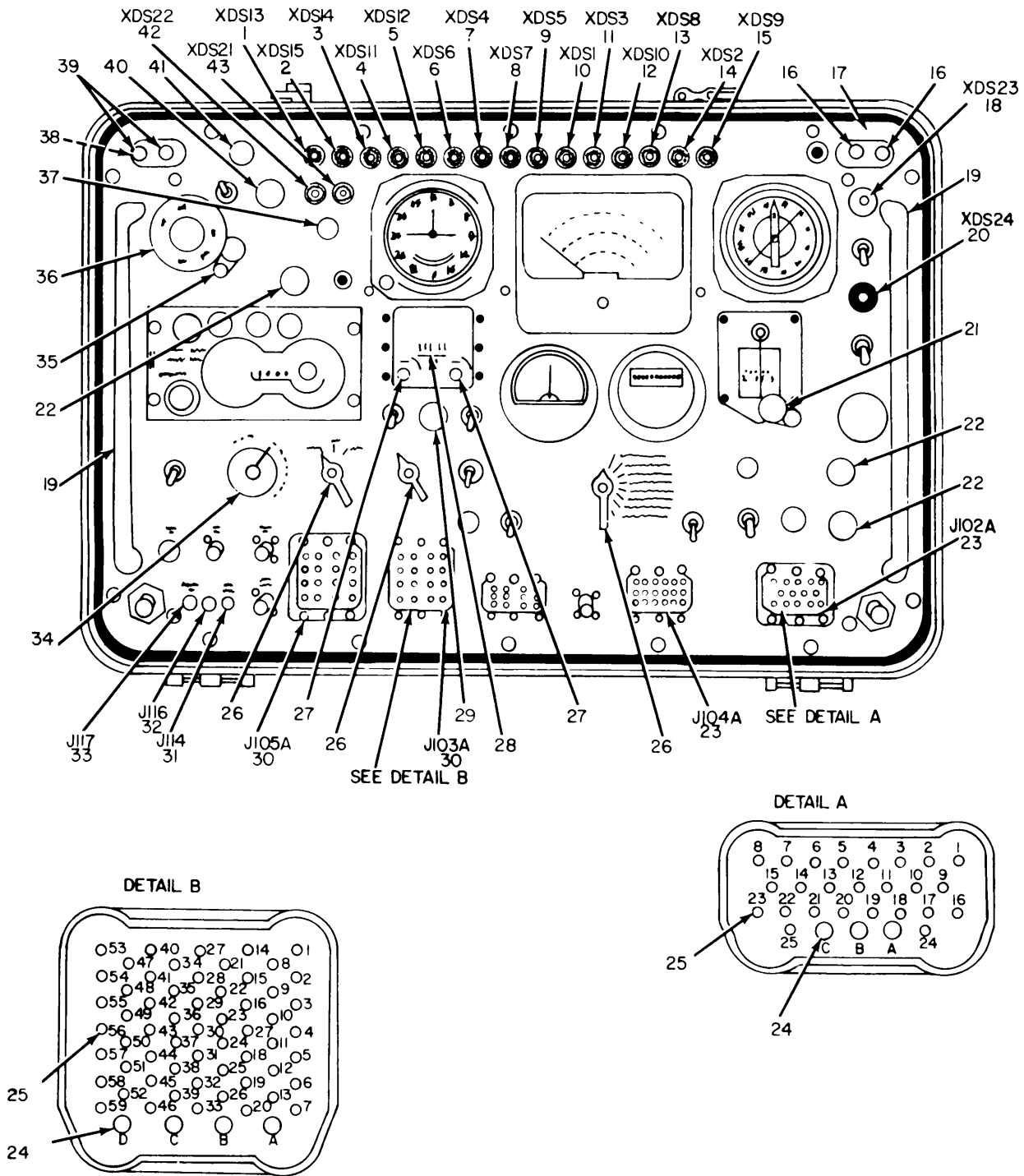

Figure 1. Test Set, Radio AN/ARM-63 (ARC Model BTK-35A)  
(Sheet 3 of 3).

SECTION II (1) ILLUSTRATION (A) (B) FIG ITEM NO NO		(2) SMR CODE	(3) NATIONAL STOCK NUMBER	(4) PART NUMBER	(5) FSCM	TM11-6625-556-40P (6) DESCRIPTION	(7) USABLE ON CODE U/M	(8) QTY INC IN UNIT
						GROUP 00 TEST SET,RADIO AN/ARM-63 (ARC MODEL BTK-35A)		
1	1	XDOHH		TS-1797/ARM-63	80058	TEST SET,RADIO TS-1797/ARM-63	EA	1
1	2	XDHZZ		29431-0001	00781	PLATE,IDENTIFICATION BTK-35A	EA	1
1	3	XDOHH		SM-295/ARM-63	80058	SIMULATOR,ANTENNA POSITION SM-295/ARM-63	EA	1
1	4	PAOZZ	5935-00-149-3534	UG-273/U	81349	ADAPTER,CABLE	EA	1
1	5	PAOZZ	5935-00-201-3090	UG-201/U	81349	ADAPTER,CABLE	EA	1
1	6	PAOZZ	5355-00-577-4665	18802	04781	DIAL,CONTROL MX-2871/ARN	EA	1
1	7	PAOZZ	5935-00-201-2408	30134	00781	ADAPTER,CONNECTOR UG-690/U	EA	1
1	8	PAOZZ	6625-00-937-4033	RFN0756	00781	ADAPTER,CONNECTOR,RADIO FREQUENCY	EA	1
1	9	PAOHH	5935-00-192-4760	7086	00781	PLUG ASSEMBLY,TIP	EA	1
1	10	PAOZZ	5120-00-590-8030	10307-0002	94375	ALIGNMENT TOOL TL-659/U	EA	1
1	11	PAOZZ	6625-00-937-4034	21330	00781	SHAFT,EXTENSION	EA	1
1	12	PAOHH	5826-00-681-9878	22048	00781	BOX,INTERCONNECTION J-1107/ARN	EA	1
1	13	PAOHH	6625-00-880-4833	CX-8748/ARM-63	80058	WIRING HARNESS,BRANCHED W4	EA	1
1	14	PAOHH	5995-00-933-7436	29419	00781	WIRING HARNESS,BRANCHED W2	EA	1
1	15	PAOHH	6625-00-880-4834	CX-8746/ARM-63	80058	WIRING HARNESS,BRANCHED W6	EA	1
1	16	PAOHH	6625-00-935-5189	CX-8747/ARM-63	80058	CABLE ASSEMBLY,BRANCHED W5	EA	1
1	17	PAOHH	6625-00-880-5081	CX-8749/ARM-63	80058	WIRING HARNESS,BRANCHED W3	EA	1
1	18	XDOHH		29418	00781	WIRING HARNESS,BRANCHED W1	EA	1
1	19	PAOHH	5995-00-933-6908	30073	00781	CABLE ASSEMBLY W10	EA	1
1	20	PAOHH	5995-00-933-6906	CX-8743/ARM-63	80058	CABLE ASSEMBLY W9	EA	1
1	21	PAOHH	5995-00-832-5227	30076	00781	CABLE ASSEMBLY W13	EA	1
1	22	PAOHH	5995-00-933-7758	30075	00781	CABLE ASSEMBLY W12	EA	1
1	23	PAOZZ	6625-00-974-6442	16158-0048	00781	LINKAGE,MECHANICAL MC-215	EA	1
1	24	PAOHH	6625-00-935-6917	CX-8739/ARM-63	80058	CABLE ASSEMBLY,POWER W16	EA	1
1	25	PAOHH	5995-00-933-6910	CX-8741/ARM-63	80058	CABLE ASSEMBLY W11	EA	1
1	26	PAOHH	6625-00-880-4835	CX-8745/ARM-63	80058	WIRING HARNESS,BRANCHED W7	EA	1
1	27	PAOHH	6625-00-880-4832	CX-8744/ARM-63	80058	WIRING HARNESS,BRANCHED W8	EA	1
1	28	XDOHH		35311	00781	CABLE ASSEMBLY,RADIO FREQUENCY W14	EA	1
1	29	PAOHH	5995-00-832-5228	30077	00781	CABLE ASSEMBLY W15	EA	1



ELOMS004

Figure 2. Test Set, Radio TS-1797/ARM-63, Front panel View.

SECTION II (1) ILLUSTRATION (A) (B) FIG ITEM NO NO		(2) SMR CODE	(3) NATIONAL STOCK NUMBER	(4) PART NUMBER	(5) FSCM	TM11-6625-556-40P (6) DESCRIPTION	USABLE ON CODE	(7) U/M	(8) QTY INC IN UNIT
						GROUP 01 TEST SET,RADIO TS-1797/ARM-63			
2	1	PAHZZ	6210-00-892-4431	21860-0101	00781	LIGH, INDICATOR		EA	1
2	2	XDHZZ		21860-0102	00781	LIGHT, INDICATOR		EA	1
2	3	PAHZZ	6210-00-892-4433	21860-0103	00781	LIGHT, INDICATOR		EA	1
2	4	PAHZZ	6210-00-892-4434	21860-0104	00781	LIGHT, INDICATOR		EA	
2	5	XDHZZ		21860-0105	00781	LIGHT, INDICATOR		EA	
2	6	XDHZZ		21860-0108	00781	LIGHT, INDICATOR		EA	
2	7	PAHZZ	6210-00-892-4437	21860-0109	00781	LIGHT, INDICATOR		EA	
2	8	PAHZZ	6210-00-892-4438	21860-0110	00781	LIGHT, INDICATOR		EA	1
2	9	PAHZZ	6210-00-892-4439	21860-0111	00781	LIGHT, INDICATOR		EA	1
2	10	PAHZZ	6210-00-892-4440	21860-0112	00781	LIGHT, INDICATOR		EA	1
2	11	PAHZZ	6210-00-892-4441	21860-0114	00781	LIGHT, INDICATOR		EA	1
2	12	PAHZZ	6210-00-892-4442	21860-0115	00781	LIGHT, INDICATOR		EA	1
2	13	PAHZZ	6210-00-892-4443	21860-0116	00781	LIGHT, INDICATOR		EA	1
2	14	XDHZZ		21860-0117	00781	LIGHT, INDICATOR		EA	1
2	15	PAHZZ	6210-00-892-4445	21860-0118	00781	LIGHT, INDICATOR		EA	1
2	16	PAHZZ	5940-00-549-9037	938D	24655	POST, BINDING		EA	2
2	17	XDHZZ		35310	00781	PANEL ASSEMBLY, FRONT		EA	1
2	18	PAHZZ	6210-00-617-1551	101-5030-931	72619	LIGHT, INDICATOR		EA	1
2	19	XDHZZ		35297	00781	HANDLE, BOW		EA	2
2	20	XDHZZ		137-8864-0931-51 2	72619	LAMPHOLDER ASSEMBLY		EA	1
2	21	PAHZZ	5830-00-496-9646	10021	00781	CRANK ASSEMBLY		EA	1
2	22	PAOZZ	5355-00-933-7740	16331-0000	00781	KNOB, SETSCREW TYPE		EA	3
2	23	PAHZZ	5935-00-937-0833	94-377	02660	CONNECTOR, RECEPTACLE, ELECTRICAL		EA	2
2	24	XDHZZ		94-467	02660	PON, SOCKET		EA	14
2	25	XHDZZ		94-466	02660	PIN, SOCKET		EA	168
2	26	PAOZZ	5355-00-933-7739	13534	00781	KNOB, SETSCREW TYPE		EA	3
2	27	PAOZZ	5355-00-863-3783	20403	00781	KNOB		EA	2
2	28	XDHHH		35305	00781	CONTROL, RECEIVER		EA	1
2	29	PAOZZ	5355-00-933-7741	24547	00781	KNOB, SETSCREW TYPE		EA	1
2	30	PAHZZ	5935-00-937-4908	94-381	02660	CONNECTOR, RECEPTACLE, ELECTRICAL		EA	2
2	31	PAHZZ	5935-00-577-2337	105-604	74970	JACK, TIP		EA	1
2	32	PAHZZ	5935-00-283-3826	105-603	74970	JACK, TIP		EA	1
2	33	PAHZZ	5935-00-133-0395	105-602	74970	JACK, TIP		EA	1
2	34	PAOZZ	5355-00-933-7743	35279	00781	KNOB, SETSCREW TYPE		EA	1
2	35	PAHZZ	5821-00-524-6627	16985	00781	CRANK ASSEMBLY		EA	1
2	36	XDHZZ		35276	00781	DIAL ASSEMBLY		EA	1
2	37	PAOZZ	5355-00-584-4300	20562-0000	00781	KNOB, SETSCREW TYPE		EA	1
2	38	XDHZZ	5970-00-755-4297	938YB	24655	INSULATOR		EA	4

SECTION II		TM11-6625-556-40P							
(1)	(2)	(3)	(4)	(5)	(6)		(7)	(8)	
ILLUSTRATION									
(A)	(B)		NATIONAL		DESCRIPTION			QTY	
FIG	ITEM	SMR	STOCK	PART		USABLE ON CODE	U/M	INC	
NO	NO	CODE	NUMBER	NUMBER	FSCM			IN	
								UNIT	
2	39	PAHZZ	5940-00-500-8717	938C	24655	POST,BINDING	EA	2	
2	40	PAOZZ	5355-00-933-7742	24546	00781	KNOB,SETSCREW TYPE	EA	1	
2	41	PAHZZ	6210-00-933-8652	VM911M10	72619	LIGH, INDICATOR	EA	1	
2	42	PAHZZ	6210-00-577-8146	101-5030-933	72619	LIGHT, INDICATOR	EA	1	
2	43	PAHZZ	6210-00-617-1552	101-5030-932	72619	LIGHT, INDICATOR	EA	1	



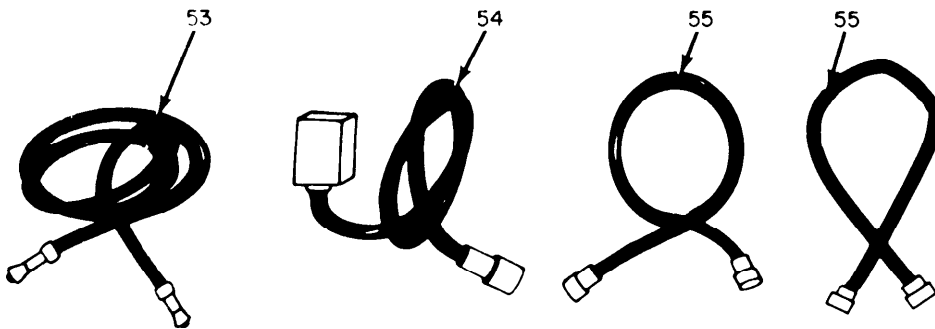
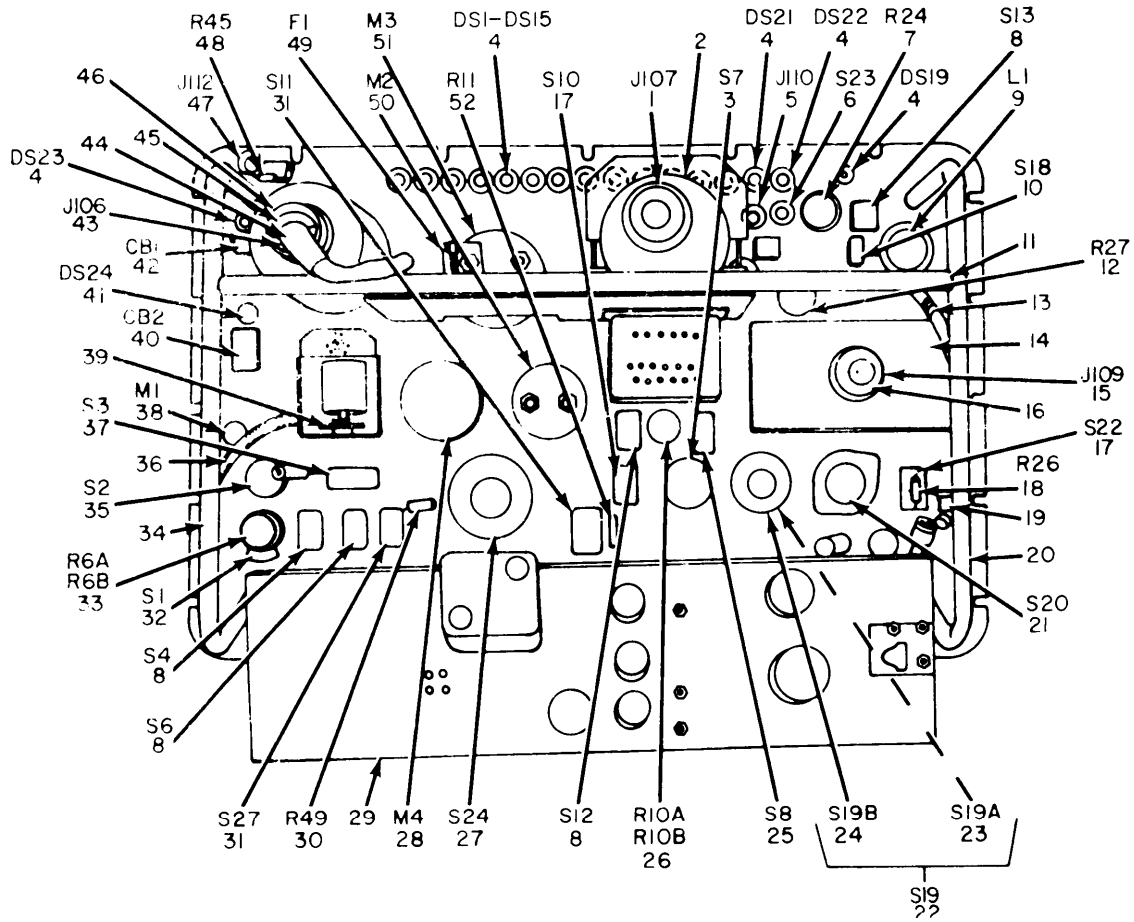

NOTE: THESE ITEMS ARE NOT SHOWN.

REF. DES.	ITEM NO.	REF. DES.	ITEM NO.
C9	56	JH5	57
C10	56	S21	8

ELOMS005

Figure 3. Test Set, Radio TS-1797/ARM-63, Chassis View.



SECTION II (1) ILLUSTRATION		(2)	(3)	(4)	(5)	TM11-6625-556-40P (6)	(7)	(8)
(A) FIG NO	(B) ITEM NO	SMR CODE	NATIONAL STOCK NUMBER	PART NUMBER	FSCM	DESCRIPTION	USABLE ON CODE	U/M INC IN UNIT
3	1	PAHZZ	5935-00-257-8311	14320	00781	CONNECTOR, RECEPTACLE, ELECTRICAL	EA	1
3	2	PAOHH	5826-00-697-9880	16706	00781	INDICATOR, COURSE ID-453/ARN-30	EA	1
3	3	PAHZZ	5930-00-982-0346	PA2039	25244	SWITCH SECTION, ROTARY	EA	1
3	4	PAOZZ	6240-00-155-7836	327	08806	LAMP, INCANDESCENT	EA	19
3	5	PAHZZ	5935-00-295-4803	4749	00781	JACK, TELEPHONE	EA	1
3	6	PAHZZ	5930-00-669-7326	13AT3	91929	SWITCH, TOGGLE	EA	1
3	7	XDHZZ		JS-5021J	01121	RESISTOR, VARIABLE	EA	1
3	8	PAHZZ	5930-00-655-1514	MS35058-22	96906	SWITCH, TOGGLE	EA	5
3	9	PAHZZ	5945-00-630-4888	17074	00781	SOLENOID	EA	1
3	10	PAHZZ	5930-00-646-4619	21241	00781	SWITCH, SENSITIVE	EA	1
3	11	XDHZZ		35252-0001	00781	ROD	EA	1
3	12	PAHZZ	5905-00-259-2800	JSB5031-FS2032	01121	RESISTOR, VARIABLE	EA	1
3	13	PAHZZ	6680-00-933-8479	16158-0014	00781	LINKAGE ASSEMBLY, MECHANICAL	EA	1
3	14	PAOHH	5820-00-534-2787	C-1827/ARC-55	80058	CONTROL UNIT, COURSE C-1827/ARC-55	EA	1
3	15	XDHZZ		K03-21-30-SN	71468	CONNECTOR, RECEPTACLE, ELECTRICAL	EA	1
3	16	XDHZZ	5935-00-642-0979	K06-21-5/8	71468	SHELL, CONNECTOR	EA	1
3	17	PAHZZ	5930-00-655-1515	MS35058-23	96906	SWITCH, TOGGLE	EA	2
3	18	PAHZZ	5905-00-279-1894	MS35043-61	96906	RESISTOR, FIXED, COMPOSITION	EA	1
3	19	XDHZZ		35252-0002	00781	ROD	EA	1
3	20	XDHZZ		35284	300781	HANDLE, BOW	EA	1
3	21	PAHZZ	5930-00-658-3867	70378-MF4	76854	SWITCH, ROTARY, UHF-VHF	EA	1
3	22	PAHZZ	5930-00-636-4735	1489	25244	SWITCH, ROTARY	EA	1
3	23	PAHZZ	5930-00-823-0856	101300FIC	76854	SWITCH, ROTARY	EA	1
3	24	PAHZZ	5930-00-823-0857	101301FIC	76854	SWITCH, ROTARY	EA	1
3	25	PAHZZ	5930-00-655-1575	MS35059-22	96906	SWITCH, TOGGLE	EA	1
3	26	PAHZZ	5905-00-933-6334	FGC-C2-95	26428	RESISTOR, VARIABLE	EA	1
3	27	PAHZZ	5930-00-916-7857	3996134	76854	SWITCH, ROTARY	EA	1
3	28	PAHZZ	6625-00-933-8598	2966	07239	METER, FREQUENCY	EA	1
3	29	XDOHH		35316	00781	PANEL ASSEMBLY, REAR	EA	1
3	30	PAHZZ	5905-00-088-3104	CDIR-901	01295	RESISTOR, FIXED, FILM	EA	1
3	31	PAHZZ	5930-00-296-5782	7665K4	27192	SWITCH, TOGGLE	EA	2
3	32	PAHZZ	5930-00-685-9521	MS35059-30	96906	SWITCH, TOGGLE	EA	1
3	33	PAHZZ	5905-00-583-8183	JJSA-1041-B5031-FS2032	01121	RESISTOR, VARIABLE	EA	1
3	34	XDHZZ		35291	00781	HANDLE, BOW	EA	1
3	35	PAHZZ	5930-00-583-6959	19982	00781	SWITCH, ROTARY	EA	1
3	36	PAHZZ	6680-00-933-8015	16158-0017	00781	LINKAGE ASSEMBLY, MECHANICAL	EA	1
3	37	PAHZZ	5930-00-583-8260	20452	00781	SWITCH, TOGGLE	EA	1
3	38	PAHZZ	6625-00-555-4385	18428	00781	MILLIAMMETER	EA	1
3	39	PAHZZ	6625-00-931-6825	35262	00781	GEAR ASSEMBLY	EA	1

SECTION II		TM11-6625-556-40P						
(1)	(2)	(3)	(4)	(5)	(6)	(7)	(8)	
ILLUSTRATION							QTY	
(A)	(B)	NATIONAL	PART		DESCRIPTION	USABLE ON CODE	INC	
FIG	ITEM	STOCK	NUMBER	FSCM			IN	
NO	NO	NUMBER	NUMBER				UNIT	
3	40	PAHZZ 5925-00-850-7244	MS24509-5	96906	CIRCUIT BREAKER		EA 1	
3	41	PAOZZ 6240-00-723-3378	NE2J	08806	LAMP,NEON		EA 1	
3	42	PAOZZ 5925-00-842-7299	MS24509-35	96906	CIRCUIT,BREAKER		EA 1	
3	43	PAHZZ 5935-00-552-2374	MS3106A22-14S	96906	CONNCTOR,RECEPTACLE,ELECTRICAL		EA 1	
3	44	PAHZZ 5365-00-141-6944	AN3420-8	81350	BUSHING,CABLE		EA 1	
3	45	PAHZZ 5935-00-223-0572	MS3057-12A	96906	CLAMP,CABLE		EA 1	
3	46	PAOHH 5826-00-505-3094	ID-250A/ARN	80058	INDICATOR,COURSE ID-250A/ARN		EA 1	
3	47	PAHZZ 5935-00-192-4729	CL2B	82389	JACK,TIP JJ-033		EA 1	
3	48	PAHZZ 5905-00-279-2545	GB-3015	01121	RESISTOR,FIXED,COMPOSITION		EA 1	
3	49	XDOZZ	8AG1/32	75915	FUSE,CARTRIDGE		EA 1	
3	50	PAHZZ 6625-00-001-1374	56-250HS	28569	AMMETER		EA 1	
3	51	PAHZZ 6625-00-931-6821	29432	00781	MULTIMETER		EA 1	
3	52	PAHZZ 5905-00-279-2616	MS35043-115	96906	RESISTOR,FIXED,COMPOSITION		EA 1	
3	53	XDOHH	11369-0072	00781	CABLE ASSEMBLY,RADIO FREQUENCY		EA 1	
3	54	XDOHH	35312	00784	CABLE ASSEMBLY,SPECIAL PURPOSE,ELECTRICAL		EA 1	
3	55	XDOHH	35324	00781	CABLE ASSEMBLY		EA 2	
3	56	XDHZZ	DM-19-511	02799	CAPACITOR,FIXED,MICA		EA 2	
3	57	PAHZZ 5935-00-201-3511	87000	30684	CONNECTOR,RECEPTACLE,ELECTRICAL		EA 1	



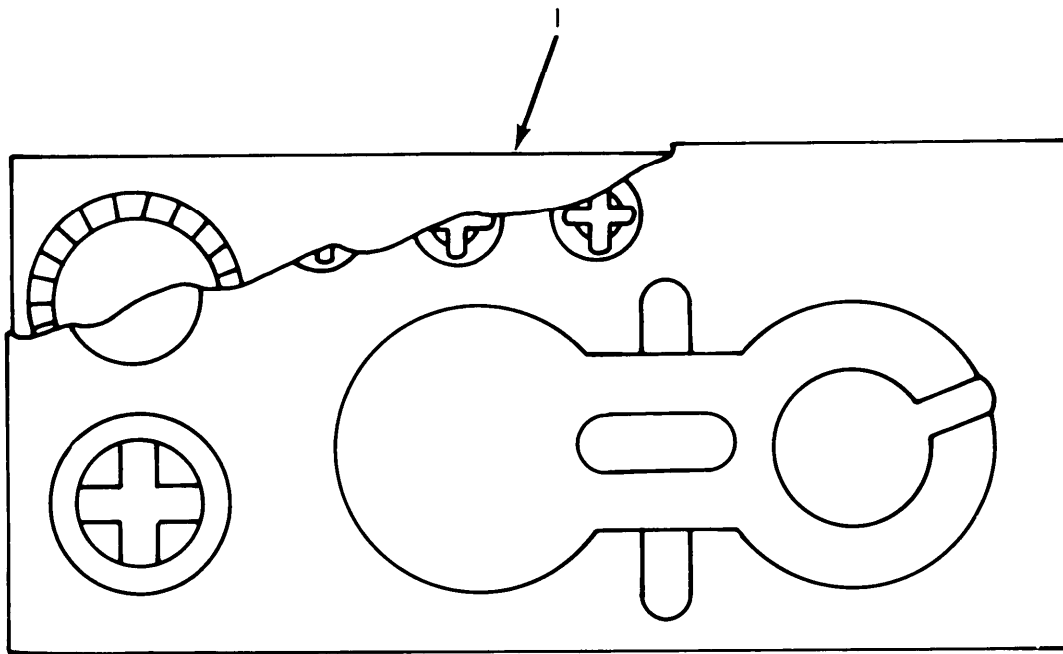

ELOMS006

Figure 4. Control Unit, Course C-1827/ARC-55.

SECTION II				TM11-6625-556-40P			
(1)	(2)	(3)	(4)	(5)	(6)	(7)	(8)
ILLUSTRATION					DESCRIPTION		QTY
(A)	(B)	NATIONAL	PART	FSCM		USABLE ON CODE	INC
FIG	ITEM	STOCK	NUMBER				IN
NO	NO	CODE	NUMBER				UNIT
					GROUP 0101 CONTROL UNIT,COURSE		
					C-1827/ARC-55		
4	1	XDHHH	23852	00781	SWITCH ASSEMBLY		EA 1

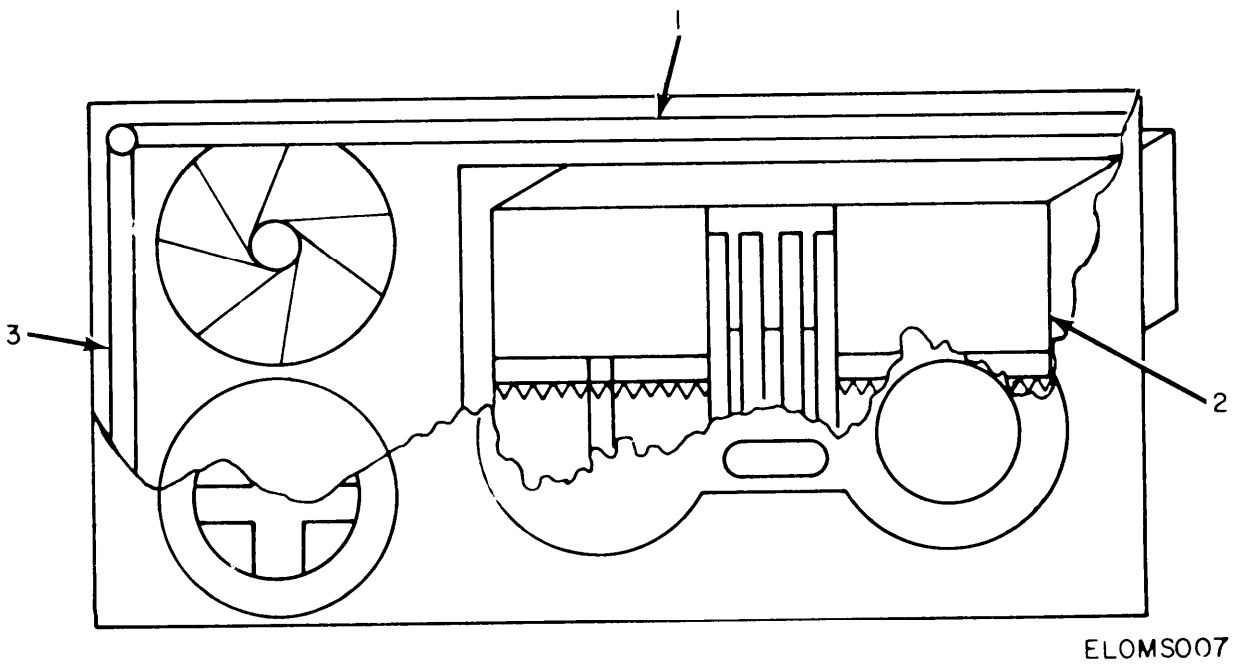
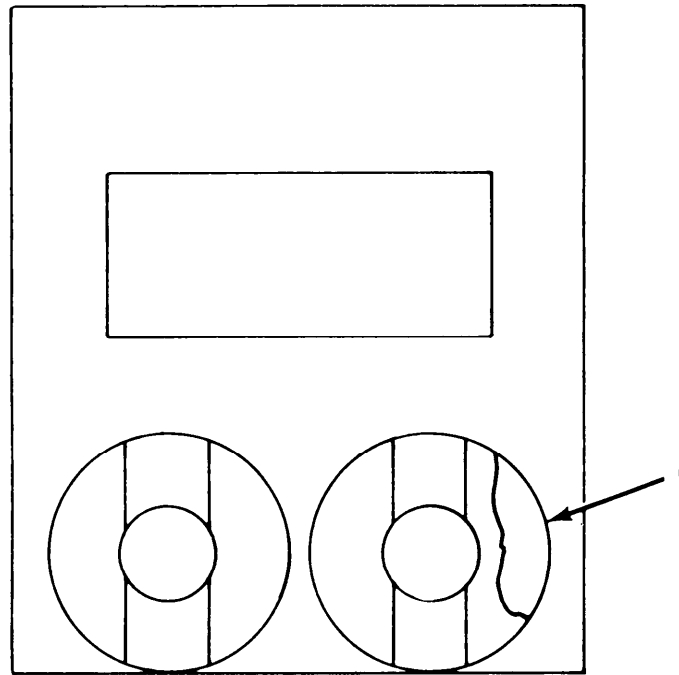

Figure 5. Switch Assembly.

SECTION II		TM11-6625-556-40P					
(1)	(2)	(3)	(4)	(5)	(6)	(7)	(8)
ILLUSTRATION							QTY
(A)	(B)	NATIONAL			DESCRIPTION		INC
FIG	ITEM	STOCK	PART	FSCM		USABLE ON CODE	IN
NO	NO	NUMBER	NUMBER				UNIT
					GROUP 010101 SWITCH ASSEMBLY		
5	1	XDHZZ	23831	00781	BRACKET ASSEMBLY		EA 1
5	2	PAHZZ	3020-00-882-4037	23589	00781	GEAR, SPUR	EA 4
5	3	XDHZZ	23734	00781	BRACKET ASSEMBLY		EA 1



ELOMS008

Figure 6. Control, Receiver.



SECTION II		TM11-6625-556-40P					
(1)	(2)	(3)	(4)	(5)	(6)	(7)	(8)
ILLUSTRATION							QTY
(A)	(B)	NATIONAL			DESCRIPTION		INC
FIG	ITEM	STOCK	PART	FSCM		USABLE ON CODE	IN
NO	NO	NUMBER	NUMBER				UNIT
					GROUP 0102 CONTROL, RECEIVER		
6	1	PAHZZ	5826-00-875-6446	23727	00781 SWITCH SUBASSEMBLY		EA 1

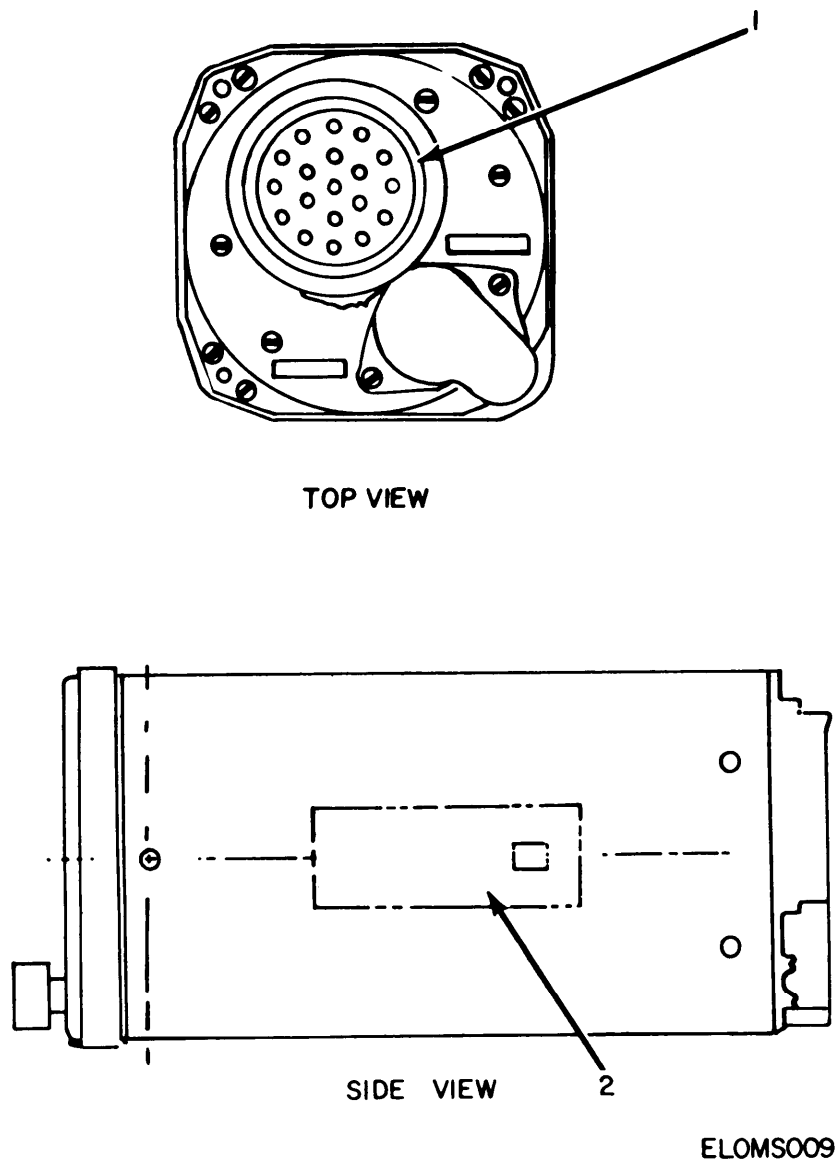

Figure 7. Indicator, Course ID-453/ARN-30.

SECTION II		TM11-6625-556-40P					
(1)	(2)	(3)	(4)	(5)	(6)	(7)	(8)
ILLUSTRATION							QTY
(A)	(B)	NATIONAL			DESCRIPTION		INC
FIG	ITEM	STOCK	PART	FSCM		USABLE ON CODE	IN
NO	NO	NUMBER	NUMBER			U/M	UNIT
					GROUP 0103 INDICATOR, COURSE ID-453/ARN-30		
7	1	PAHZZ	5935-00-511-8455	16711	00781 RECEPTACLE ASSEMBLY		EA 1
7	2	XDHZZ		25305-XXXX	00781 PLATE, IDENTIFICATION		EA 1

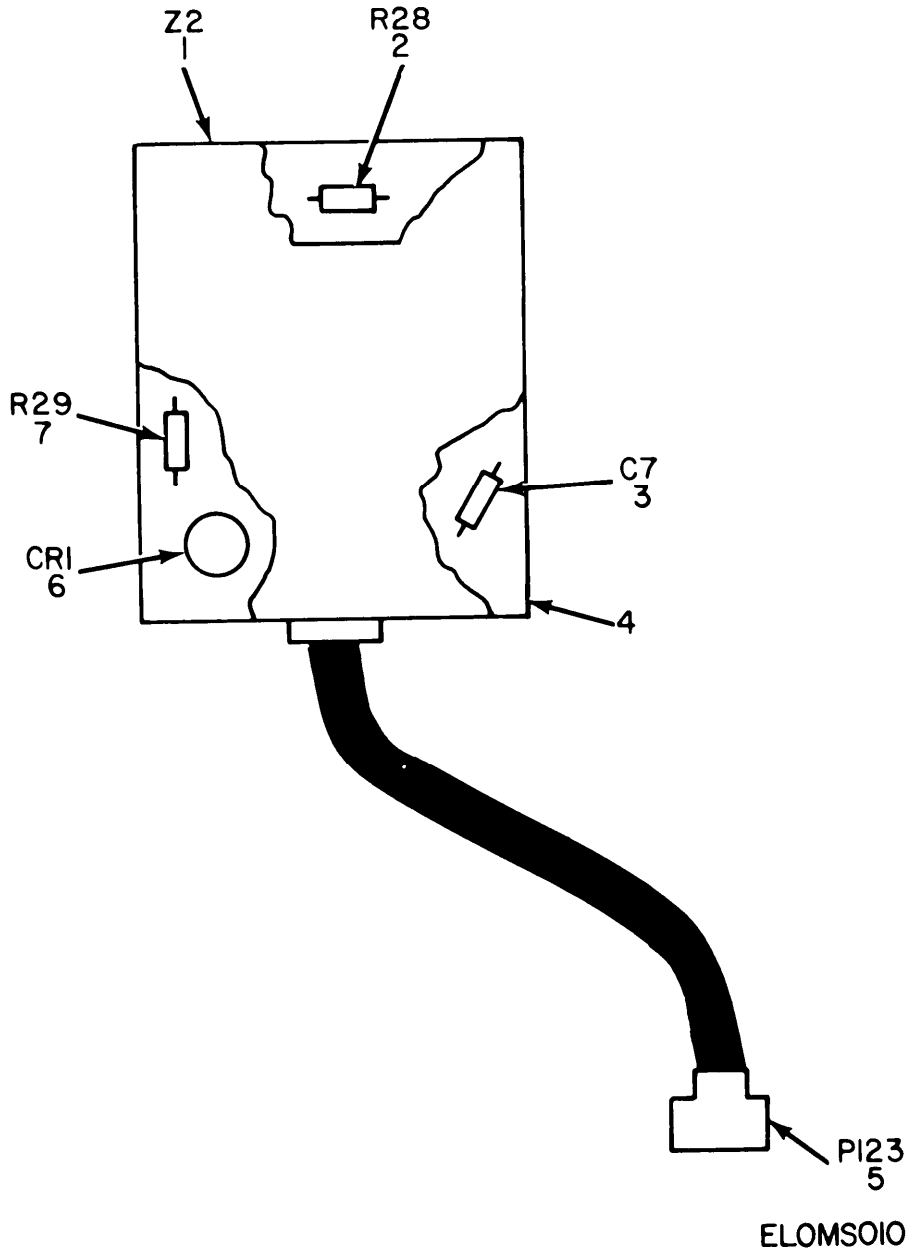

Figure 8. Cable Assembly, Special Purpose.

SECTION II		TM11-6625-556-40P					
(1)	(2)	(3)	(4)	(5)	(6)	(7)	(8)
ILLUSTRATION							QTY
(A)	(B)	NATIONAL			DESCRIPTION		INC
FIG	ITEM	STOCK	PART	FSCM		USABLE ON CODE	IN
NO	NO	NUMBER	NUMBER				UNIT
					GROUP 0105 CABLE ASSEMBLY,SPECIAL PURPOSE		
8	1	XDHZZ	23771	00781	BOX,CONNECTOR		EA 1
8	2	PAHZZ	5905-00-190-8887	MS35043-94	96906 RESISTOR, FIXED, COMPOSITION		EA 1
8	3	PAHZZ	5910-00-615-0105	CC30UJ101J	81349 CAPACITOR, FIXED, CERAMIC		EA 1
8	4	XDHZZ	23759	00781	BASE ASSEMBLY		EA 1
8	5	PAHZZ	5935-00-823-0487	UG-88/U	81349 CONNECTOR, PLUG, ELECTRICAL		EA 1
8	6	PAHZZ	5961-00-853-2607	1N295	81349 SEMICONDUCTOR DEVICE, DIODE		EA 1
8	7	PAHZZ	5905-00-254-9201	MS35043-127	96906 RESISTOR, FIXED, COMPOSITION		EA 1

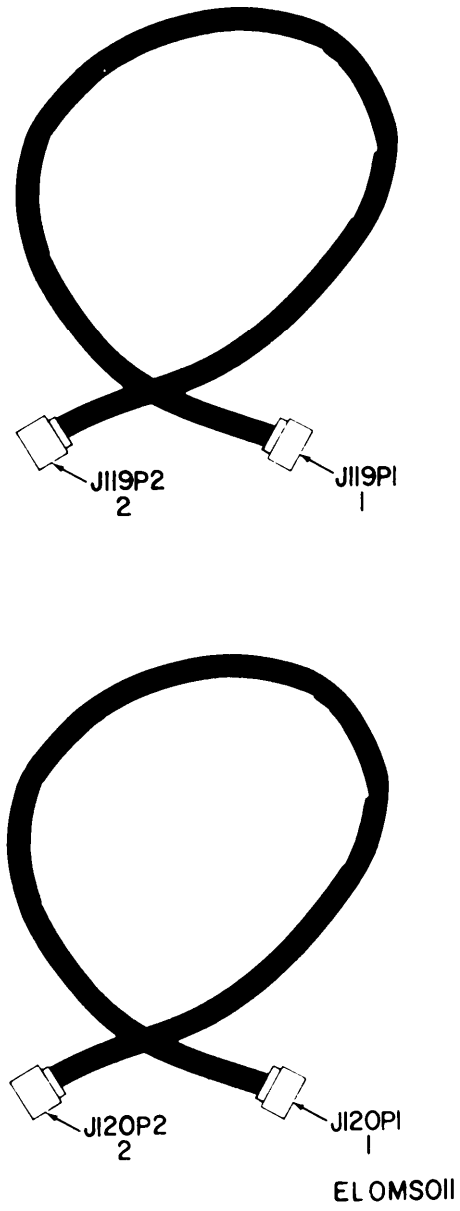

Figure 9. Cable Assembly.

SECTION II		TM11-6625-556-40P						
(1)	(2)	(3)	(4)	(5)	(6)	(7)	(8)	
ILLUSTRATION							QTY	
(A)	(B)	NATIONAL			DESCRIPTION		INC	
FIG	ITEM	STOCK	PART	FSCM		USABLE ON CODE	IN	
NO	NO	NUMBER	NUMBER				UNIT	
					GROUP 0106 CABLE ASSEMBLY			
9	1	PAHZZ	5935-00-539-4282	UG291/U	81349	CONNECTOR, RECEPTACLE, ELECTRICAL	EA 2	
9	2	PAHZZ	5935-00-149-4066	UG-88/U	81349	CONNECTOR, PLUG, ELECTRICAL	EA 2	

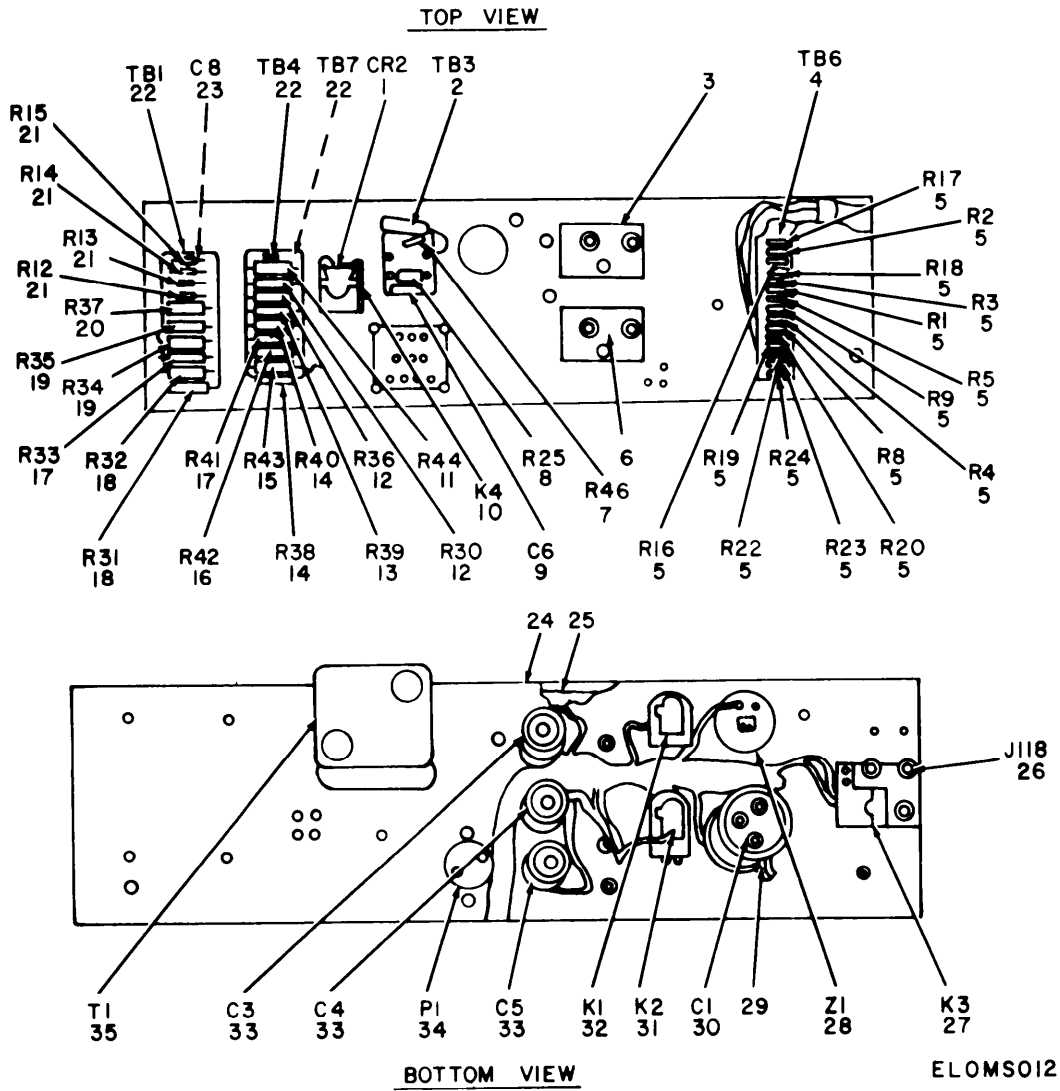
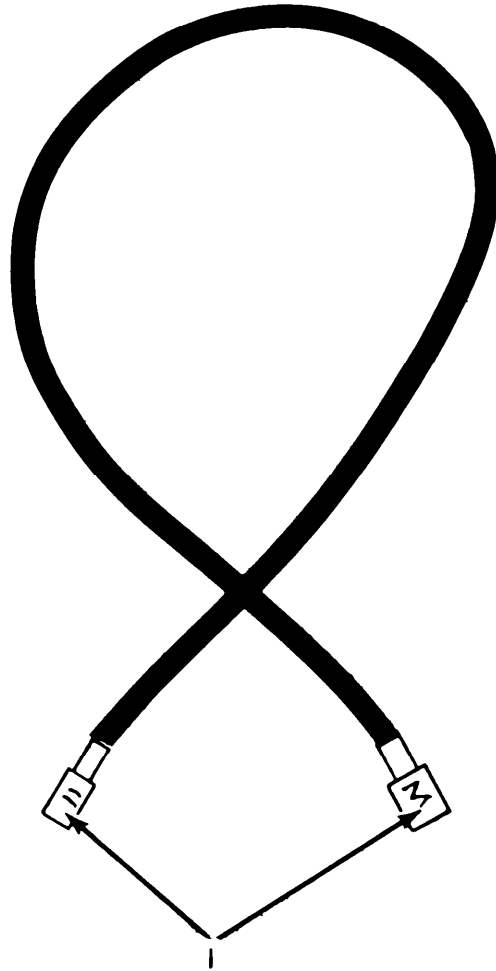

Figure 10. Rear Panel Assembly.



SECTION II (1) ILLUSTRATION (A) FIG NO		(2) SMR CODE	(3) NATIONAL STOCK NUMBER	(4) PART NUMBER	(5) FSCM	TM11-6625-556-40P (6) DESCRIPTION	(7) USABLE ON CODE U/M	(8) QTY INC IN UNIT
						GROUP 0107 REAR PANEL ASSEMBLY		
10	1	PAHZZ	6130-00-027-4029	B160	88141	RECTIFIER,METALLIC	EA	1
10	2	XDHZZ	5940-00-518-7648	13025	00781	TERMINAL BOARD	EA	1
10	3	PAHZZ	6625-00-926-7771	35355-0030	00781	SHUNT, INSTRUMENT	EA	1
10	4	XDHZZ		35278	00781	TERMINAL BOARD	EA	1
10	5	PAHZZ	5905-00-106-9344	MS35043-63	96906	RESISTOR, FIXED, COMPOSITION	EA	15
10	6	PAHZZ	6625-00-931-6823	35355-0005	00781	SHUNT, INSTRUMENT	EA	1
10	7	PAHZZ	5905-00-884-1527	CD1/2PR30	01295	RESISTOR, FIXED, FILM	EA	1
10	8	PAHZZ	5905-00-279-2557	MS35044-64	96906	RESISTOR, FIXED, COMPOSITION	EA	1
10	9	XDHZZ		110D205X0150G0	56289	CAPACITOR, FIXED, ELECTROLYTIC	EA	1
10	10	PAHZZ	5945-00-238-7927	12713	300781	RELAY ASSEMBLY	EA	1
10	11	PAHZZ	5905-00-586-9580	CD1/2PR-135	01295	RESISTOR, FIXED, FILM	EA	1
10	12	PAHZZ	5905-00-792-6616	CD1/2PR-271	01295	RESISTOR, FIXED, FILM	EA	2
10	13	PAHZZ	5905-00-078-8763	CDIR-614	01295	RESISTOR, FIXED, FILM	EA	1
10	14	PAHZZ	5905-00-587-0707	CD1/2PRM33.2K	01295	RESISTOR, JFIXED, FILM	EA	2
10	15	XDHZZ		CD1/2PR-204	01295	RESISTOR, FIXED, FILM	EA	1
10	16	PAHZZ	5905-00-586-9671	CD1/2PR-593	01295	RESISTOR, FIXED, FILM	EA	1
10	17	PAHZZ	5905-00-586-9823	CD1/2PR-514	01295	RESISTOR, FIXED, FILM	EA	2
10	18	PAHZZ	5905-00-954-5581	CDIR-235	01295	RESISTOR, FIXED, FILM	EA	2
10	19	PAHZZ	5905-00-933-8494	CDIR-295	01295	RESISTOR, FIXED, FILM	EA	2
10	20	PAHZZ	5905-00-792-1581	CD1/2PR-163	01295	RESISTOT, FIXED, FILM	EA	1
10	21	PAHZZ	5905-00-195-6806	MS35043-87	96906	RESISTOR, FIXED, COMPOSITION	EA	4
10	22	XDHZZ	5940-00-549-1072	14079	00781	TERMINAL BOARD	EA	3
10	23	PAHZZ	5910-00-754-7081	150D10CX0035R2	56289	CAPACITOR, FIXED, ELECTROPYTIC	EA	1
10	24	XDHZZ		35226	00781	PANEL REAR	EA	1
10	25	XDHZZ	5910-00-392-5931	15535	00781	MOUNTING ASSEMBLY	EA	3
10	26	PAHZZ	5935-00-201-3511	23739	00781	CONNECTOR, RECEPTACLE, ELECTRICAL	EA	1
10	27	PAHZZ	5999-00-978-7453	54000	94375	RELAY, SWITCH	EA	1
10	28	PAHZZ	5915-00-536-3370	16798	00781	FILTER ASSEMBLY, AUDIO	EA	1
10	29	XDHZZ		28702	00781	CLAMP, CAPACITOR	EA	1
10	30	XDHZZ		CE32C250J	81349	CAPACITOR, FIXED, ELECTROLYTIC	EA	1
10	31	PAHZZ	5945-00-933-7485	24966-0028	00781	RELAY ASSEMBLY	EA	1
10	32	XDHZZ		14485	00781	RELAY ASSEMBLY	EA	1
10	33	PAHZZ	5910-00-880-4509	D30913	00781	CAPACITOR, FIXED, ELECTROLYTIC	EA	3
10	34	PAHZZ	5935-00-644-6750	7467	00781	CONNECTOR, RECEPTACLE	EA	1
10	35	XDHZZ		TF4SX02FA	80058	TRANSFORMER, POWER, STEP DOWN TF4SX02FA	EA	1



ELOMS 3

Figure 11. Cable Assembly.

SECTION II		TM11-6625-556-40P					
(1)	(2)	(3)	(4)	(5)	(6)	(7)	(8)
ILLUSTRATION							QTY
(A)	(B)	NATIONAL			DESCRIPTION		INC
FIG	ITEM	STOCK	PART	FSCM		USABLE ON CODE	IN
NO	NO	NUMBER	NUMBER				UNIT
					GROUP 0108 CABLE ASSEMBLY		
11	1	PAHZZ	5935-00-149-4066	UG-88/U	81349	CONNECTOR, PLUG	EA 2

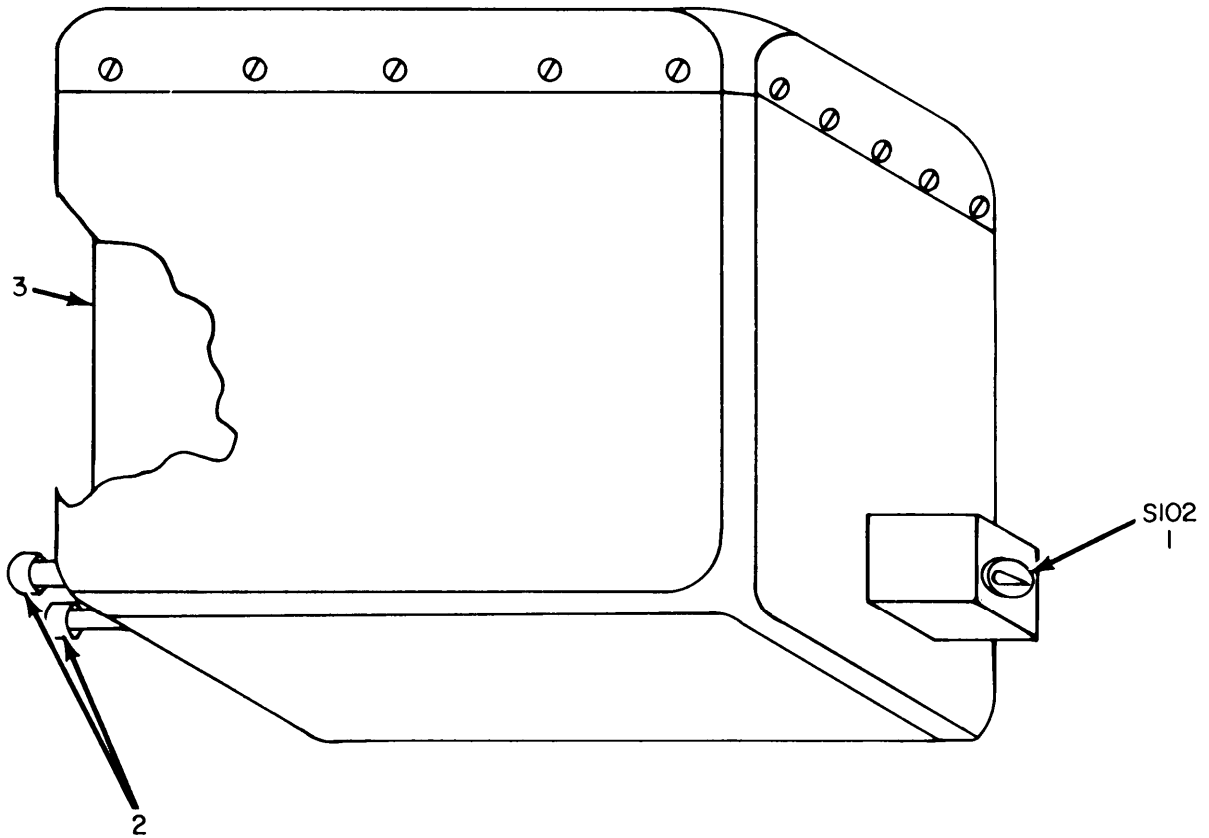

NOTE: THESE ITEMS ARE NOT SHOWN.

REF DES.	ITEM NO.	REF DES.	ITEM NO.	REF DES.	ITEM NO.	REF DES.	ITEM NO.
C101	4	C104	7	J102	9	R103	12
C102	5	C105	8	R101	10	S101	13
C103	6	J101	9	R102	11		

ELOMS014

Figure 12. Simulator, Antenna Position SM-295/ARM-63.

SECTION II						TM11-6625-556-40P		
(1)	(2)	(3)	(4)	(5)	(6)	(7)	(8)	
ILLUSTRATION								
(A)	(B)	NATIONAL			DESCRIPTION		QTY	
FIG	ITEM	STOCK	PART	FSCM		USABLE ON CODE	INC	
NO	NO	NUMBER	NUMBER				IN	
							UNIT	
					GROUP 02 SIMULATOR,ANTENNA POSITION			
					SM-295/ARM-63			
12	1	PAHZZ	5930-00-982-0345	3991217-A	76854		EA 1	
12	2	PAHZZ	5935-00-201-2469	14747	00781		EA 2	
12	3	XDOHH		35260	00781		EA 1	
12	4	PAHZZ	5910-00-240-2878	TC25	71590		EA 1	
12	5	PAHZZ	5910-00-982-0401	CC30UJ11J	81349		EA 1	
12	6	PAHZZ	5910-00-726-2448	TC20A	71590		EA 1	
12	7	PAHZZ	5910-00-933-6372	801000X5F102K	72982		EA 1	
12	8	PAHZZ	5910-00-933-6371	2500003-01651U2J U360J	72982		EA 1	
12	9	PAHZZ	5935-00-201-3511	87000	30684		EA 2	
12	10	PAHZZ	5905-00-581-1010	RN70B6810F	81349		EA 1	
12	11	PAHZZ	5905-00-581-4980	RN70B1741F	81349		EA 1	
12	12	PAHZZ	5905-00-542-9790	RN70B1101F	81349		EA 1	
12	13	PAHZZ	5930-00-655-1508	MS25100-23	96906		EA 1	

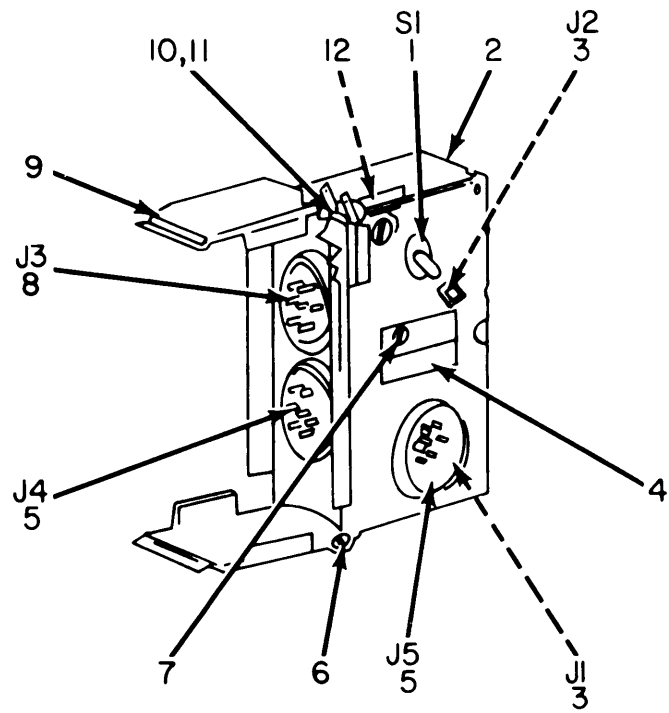

NOTE: FOR COMPLETE REFERENCE  
DESIGNATION PREFIX WITH AI.  
ELOMS015

Figure 13. Box, Interconnecting J-1107/ARN.

SECTION II		TM11-6625-556-40P						
(1)	(2)	(3)	(4)	(5)	(6)	(7)	(8)	
ILLUSTRATION								
(A)	(B)	NATIONAL			DESCRIPTION		QTY	
FIG	ITEM	STOCK	PART	FSCM		USABLE ON CODE	INC	
NO	NO	NUMBER	NUMBER				IN	
							UNIT	
					GROUP 03 BOX, INTERCONNECTING J-1107.ARN			
13	1	PAHZZ	5930-00-556-9530	23AT3	91929		EA 1	
13	2	XDHZZ		22045	00781		EA 1	
13	3	PAHZZ	5935-00-257-9735	5488	00781		EA 2	
13	4	XDHZZ		22390-XXXX	00781		EA 1	
13	5	PAHZZ	5935-00-259-5315	12348	00781		EA 2	
13	6	XDHZZ		503-0016	00781		EA 8	
13	7	XDHZZ		8081	00781		EA 2	
13	8	XDHZZ	5935-00-542-8182	15834	00781		EA 1	
13	9	XDHZZ		22044	00781		EA 1	
13	10	XDHZZ		1703	78189		EA 1	
13	11	XDHZZ		153-0020	00781		EA 1	
13	12	XDHZZ		20789	00781		EA 1	

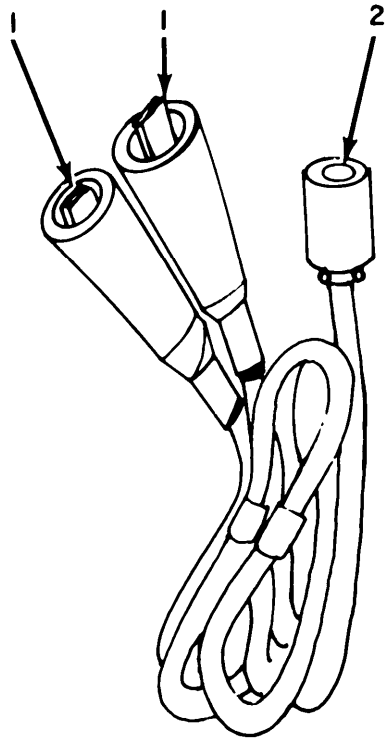

ELOMSO16

Figure 14. Cable Assembly, Power CX-8739/ARM-63.



SECTION II		TM11-6625-556-40P					
(1)	(2)	(3)	(4)	(5)	(6)	(7)	(8)
ILLUSTRATION					DESCRIPTION		QTY
(A)	(B)	NATIONAL	PART	FSCM		USABLE ON CODE	INC
FIG	ITEM	STOCK	NUMBER				IN
NO	NO	CODE	NUMBER				UNIT
					GROUP 04 CABLE ASSEMBLY,POWER		
					CX-8739/ARM-63		
14	1	PAHZZ	5999-00-204-8350	24C	76545		EA 2
14	2	PAHZZ	5935-00-929-4864	7427	72268		EA 1

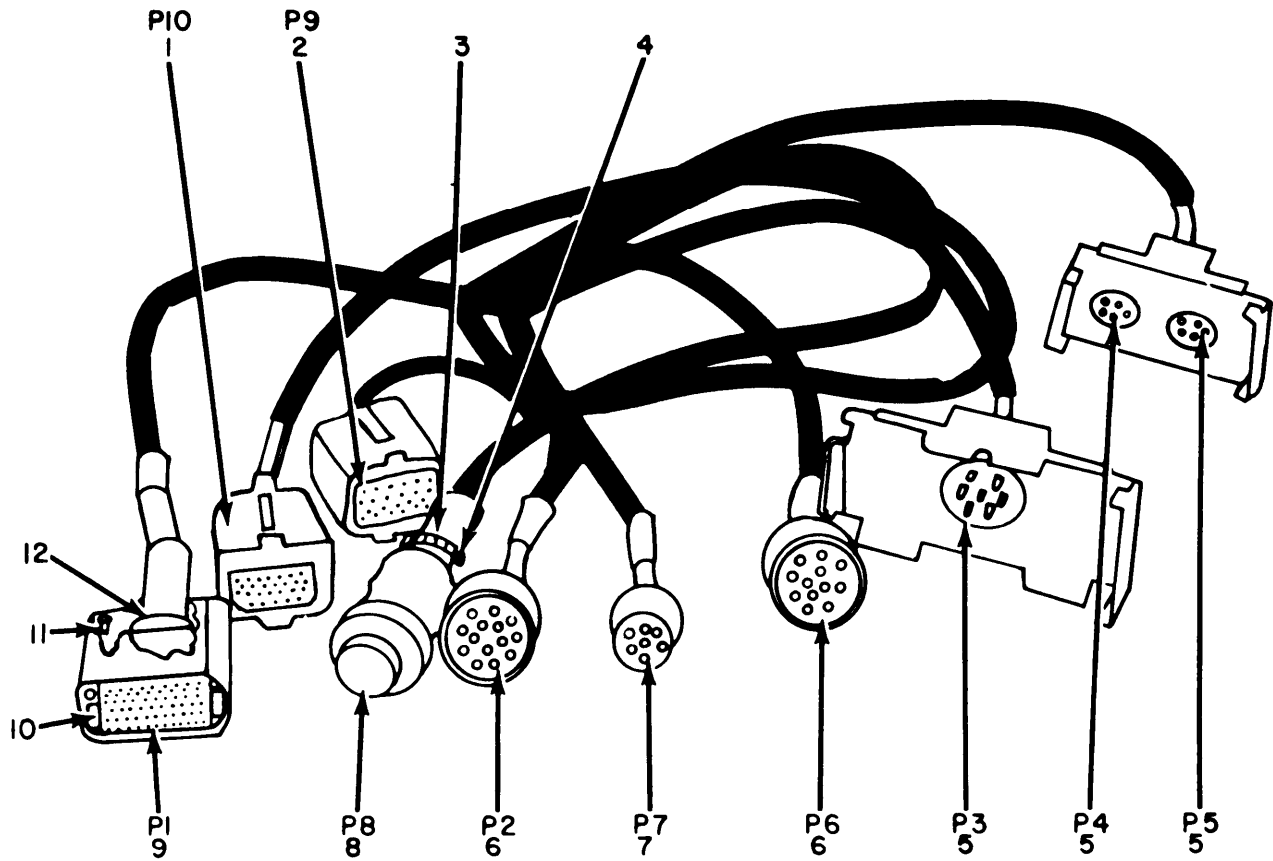

NOTE: FOR COMPLETE REFERENCE DESIGNATIONS  
PREFIX WITH WI.

ELOMS017

Figure 15, Wiring Harness, Branched CX-8749/ARM-63.

SECTION II (1) ILLUSTRATION (A) (B) FIG ITEM NO NO		(2) SMR CODE	(3) NATIONAL STOCK NUMBER	(4) PART NUMBER	(5) FSCM	TM11-6625-556-40P (6) DESCRIPTION	(7) USABLE ON CODE U/M	(8) QTY INC IN UNIT
						GROUP 05 WIRING HARNESS,BRANCHED		
						CX-8749/ARM-63		
15	1	PAHZZ	5935-00-937-4151	29434-4000	00781	CONNECTOR ASSEMBLY	EA	1
15	2	PAHZZ	5935-00-937-4150	29433	00781	CONNECTOR ASSEMBLY	EA	1
15	3	XDHZZ		24208	00781	CLAMP ASSEMBLY	EA	6
15	4	XDHZZ		164-0040	00781	SCREW,MACHINE	EA	4
15	5	PAHZZ	5935-00-542-8182	15834	00781	CONNECTOR,RECEPTACLE	EA	3
15	6	PAHZZ	5935-00-549-4212	16115	02660	CONNECTOR,PLUG	EA	2
15	7	PAHZZ	5935-00-295-5438	14050	00781	CONNECTOR,PLUG	EA	1
15	8	PAHZZ	5935-00-859-2641	22448	00781	CONNECTOR ASSEMBLY	EA	1
15	9	PAHZZ	5935-00-937-4139	35345-1000	00781	CONNECTOR ASSEMBLY	EA	1
15	10	XDHZZ		164-0044	00781	SCREW,MACHINE	EA	2
15	11	XDHZZ		166-0100	00781	SCREW,MACHINE	EA	2
15	12	XDHZZ		24240	00781	GROMMET,RUBBER	EA	1

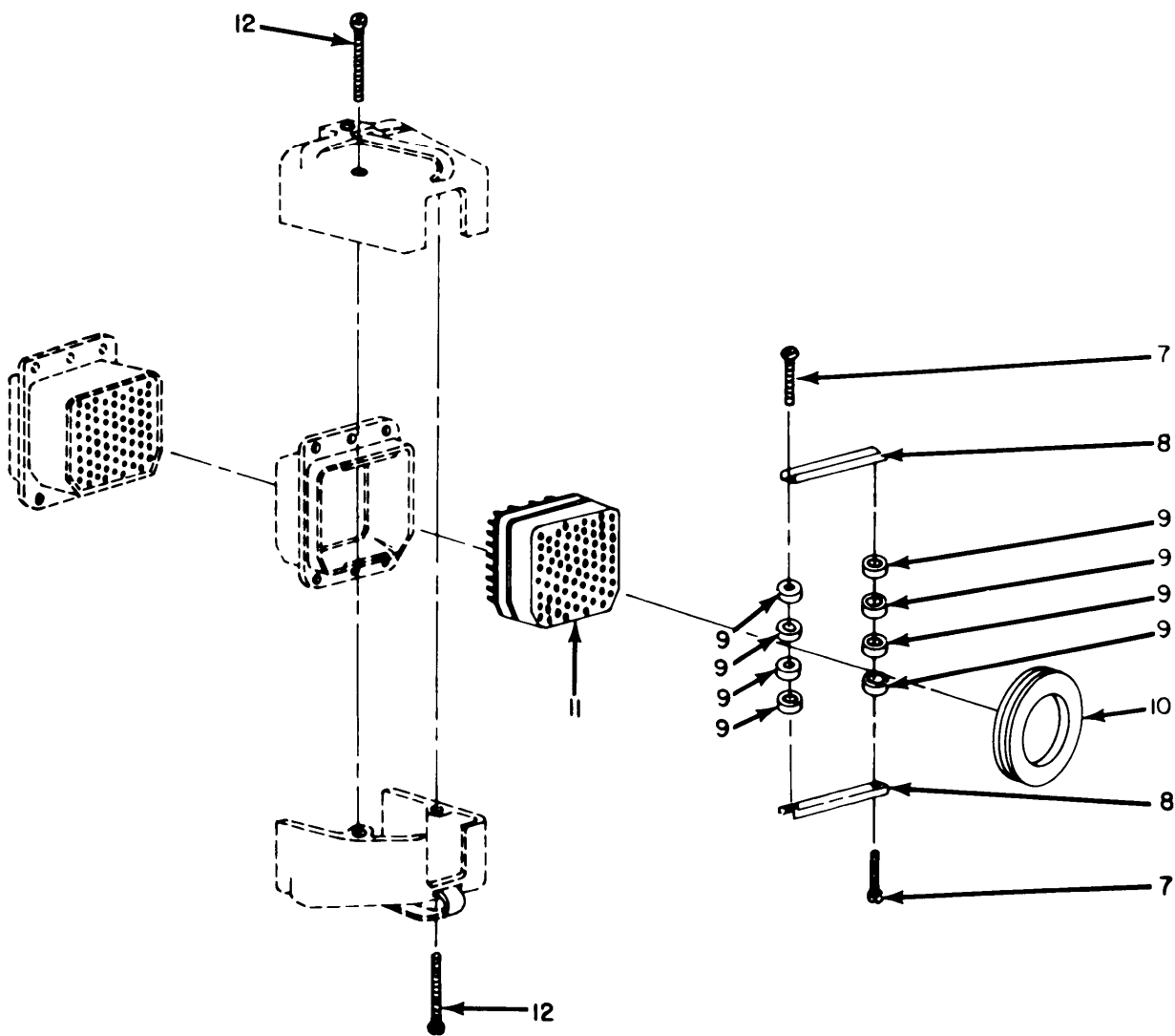
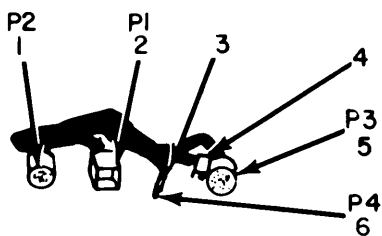

NOTE: FOR COMPLETE REFERENCE  
DESIGNATION PREFIX WITH W2.

ELOMS018

Figure 16. Wiring Harness, Branched W2.

SECTION II						TM11-6625-556-40P		
(1)	(2)	(3)	(4)	(5)	(6)	(7)	(8)	
ILLUSTRATION								
(A)	(B)	NATIONAL			DESCRIPTION		QTY	
FIG	ITEM	STOCK	PART	FSCM		USABLE ON CODE	INC	
NO	NO	NUMBER	NUMBER				IN	
							UNIT	
					GROUP 06 WIRING HARNESS,BRANCHED W2			
16	1	PAHZZ	5935-00-552-2670	MS3106A24-5S/C/	96906	CONNECTOR,RECEPTACLE	EA 1	
16	2	PAHZZ	6625-00-974-6439	35345-2000	00781	CONNECTOR ASSEMBLY	EA 1	
16	3	XDHZZ		35388-2004	81349	TAG	EA 2	
16	4	PAHZZ	5935-00-280-2353	MS3057-16A	96906	CLAMP,CABLE	EA	
16	5	PAHZZ	5935-00-846-8101	MS3108B24-7S/C1/	96906	CONNECTOR,RECEPTACLE	EA	
16	6	PAHZZ	5935-00-149-2703	JAN-P-642	81349	PLUG,TIP	EA	
16	7	XDHZZ		164-0044	00781	SCREW,MACHINE	EA	
16	8	XDHZZ		24539	00781	CLAMP ASSEMBLY	EA 2	
16	9	XDHZZ		22434	00781	INSULATOR	EA 8	
16	10	XDHZZ		24240	00781	GROMMET	EA 1	
16	11	XDHZZ		94-65940-2	00781	CONNECTOR,RECEPTACLE	EA 1	
16	12	XDHZZ		166-0100	00781	SCREW,MACHINE	EA 2	

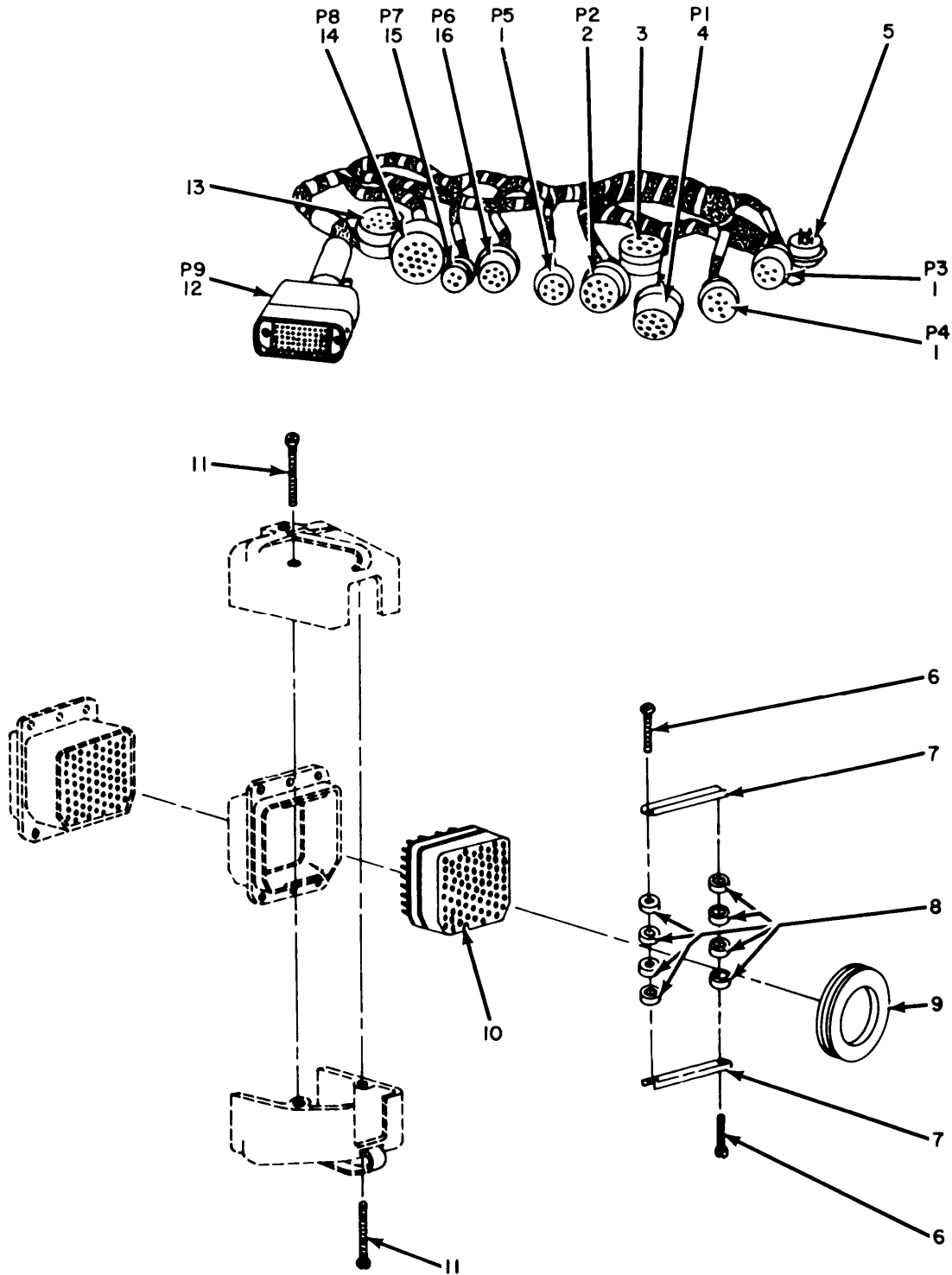

NOTE: FOR COMPLETE REFERENCE DESIGNATION  
PREFIX WITH W3.

ELOMS019

Figure 17. Wiring Harness, Branched W3.

SECTION II		TM11-6625-556-40P						
(1)	(2)	(3)	(4)	(5)	(6)	(7)	(8)	
ILLUSTRATION								
(A)	(B)	NATIONAL			DESCRIPTION		QTY	
FIG	ITEM	STOCK	PART	FSCM		USABLE ON CODE	INC	
NO	NO	NUMBER	NUMBER				IN	
							UNIT	
		SMR						
		CODE						
					GROUP 07 WIRING HARNESS,BRANCHED W3			
17	1	PAHZZ	5935-00-295-5437	14051	00781 CONNECTOR,PLUG,ELECTRICAL		EA 3	
17	2	PAHZZ	5935-00-549-3834	16744	00781 CONNECTOR,PLUG		EA 1	
17	3	PAHZZ	5935-00-685-9885	18730	00781 PLUG,SHORTING,ELECTRICAL		EA 1	
17	4	PAHZZ	5935-00-549-3835	16743	00781 CONNECTOR,PLUG		EA 1	
17	5	XDHZZ		19237	00781 PLUG,SHORTING,ELECTRICAL		EA 1	
17	6	XDHZZ		164-0044	00781 SCREW,MACHINE		EA 2	
17	7	XDHZZ		24539	00781 CLAMP ASSEMBLY		EA 2	
17	8	XDHZZ		22434	00781 INSULATOR		EA 8	
17	9	XDHZZ		24240	00781 GROMMET		EA 1	
17	10	XDHZZ		94-65940-2	00781 CONNECTOR,RECEPTACLE		EA 1	
17	11	XDHZZ		166-0100	00781 SCREW,MACHINE		EA 2	
17	12	PAHZZ	6625-00-974-6439	35345-2000	00781 CONNECTOR ASSEMBLY,ELECTRICAL		EA 1	
17	13	PAHZZ	5935-00-630-5442	18740	00781 PLUG,SHORTING,ELECTRICAL		EA 1	
17	14	PAHZZ	5935-00-549-4212	16115	00781 CONNECTOR,PLUG		EA 1	
17	15	PAHZZ	5935-00-295-5440	14052	00781 CONNECTOR,PLUG,ELECTRICAL		EA 1	
17	16	PAHZZ	5935-00-295-5438	14050	00781 CONNECTOR,PLUG		EA 1	

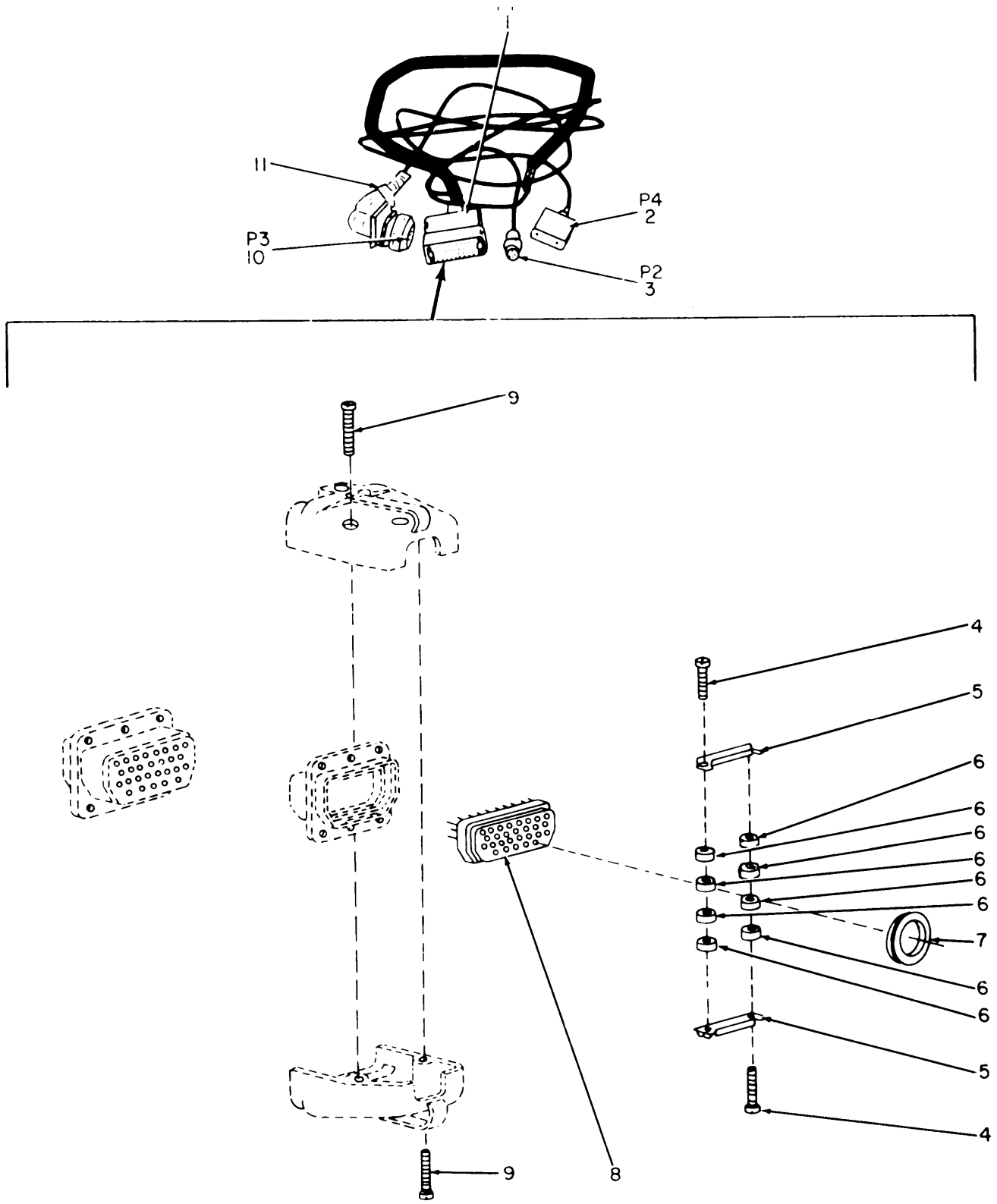

NOTE: FOR COMPLETE REFERENCE DESIGNATION  
 PREFIX WITH W4.

ELOMS020

Figure 18. Wiring Harness, Branched W4.



SECTION II		TM11-6625-556-40P					
(1)	(2)	(3)	(4)	(5)	(6)	(7)	(8)
ILLUSTRATION							
(A)	(B)	NATIONAL			DESCRIPTION		QTY
FIG	ITEM	STOCK	PART	FSCM		USABLE ON CODE	INC
NO	NO	NUMBER	NUMBER				IN
							UNIT
					GROUP 08 WIRING HARNESS,BRANCHED W4		
18	1	PAHZZ	5935-00-937-4152	29434-2000	00781	CONNECTOR ASSEMBLY	EA 1
18	2	XDHZZ		MRE9S-JTC6H	81312	CONNECTOR,PLUG	EA 1
18	3	PAHZZ	5935-00-633-6246	MM5-11-5/16	71468	CONNECTOR,PLUG	EA 1
18	4	XDHZZ		164-0040	00781	SCREW,MACHINE	EA 2
18	5	XDHZZ		24208	00781	CLAMP ASSEMBLY	EA 2
18	6	XDHZZ		22434	00781	INSULATOR	EA 8
18	7	XDHZZ		24241	00781	GROMMET	EA 1
18	8	XDHZZ		94-42530-2	00781	CONNECTOR,RECEPTACLE	EA 1
18	9	XDHZZ		165-0048	00781	SCREW,MACHINE	EA 2
18	10	XDHZZ		MS3108A18-9S	96906	CONNECTOR,PLUG	EA 1
18	11	PAHZZ	5935-00-809-0786	MS3057-10A	96906	CLAMP,CABLE	EA 1

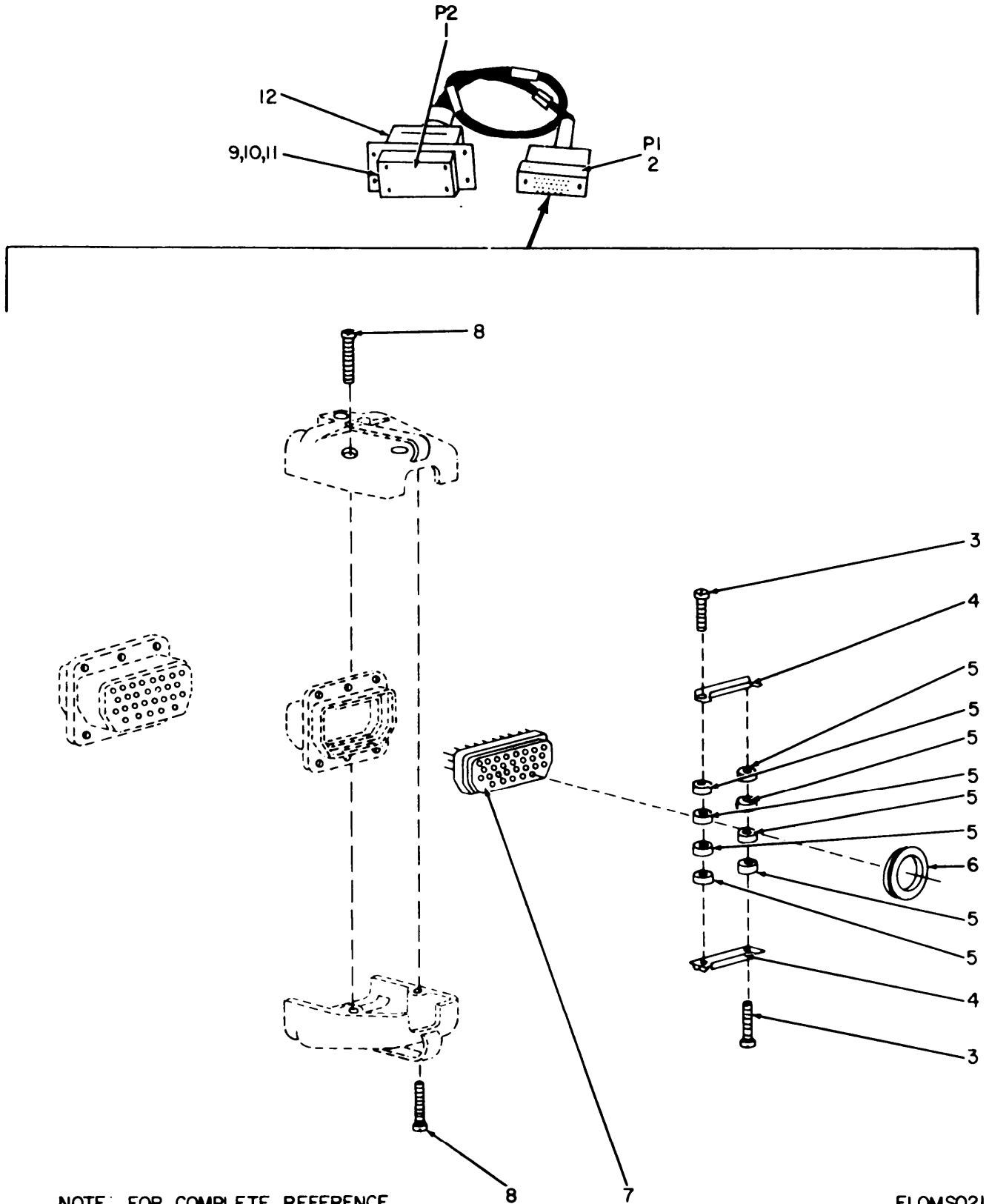

Figure 19. Cable Assembly W5.

SECTION II						TM11-6625-556-40P		
(1)	(2)	(3)	(4)	(5)	(6)	(7)	(8)	
ILLUSTRATION								
(A)	(B)	NATIONAL			DESCRIPTION		QTY	
FIG	ITEM	STOCK	PART	FSCM		USABLE ON CODE	INC	
NO	NO	NUMBER	NUMBER				IN	
							UNIT	
					GROUP 09 CABLE ASSEMBLY W5			
19	1	PAHZZ	5935-00-513-2373	DPD32-335-IL	71468		EA	
19	2	PAHZZ	5935-00-937-4153	29434-3000	00781		EA	
19	3	XDHZZ		164-0040	00781		EA	
19	4	XDHZZ		24208	00781		EA	
19	5	XDHZZ		22434	00781		EA	
19	6	XDHZZ		24241	00781		EA	
19	7	XDHZZ		94-42530-2	00781		EA	
19	8	XDHZZ		166-0048	00781		EA	
19	9	XDHZZ		146-0032	00781		EA	
19	10	XDHZZ	5310-00-616-3555	1706	78189		EA	
19	11	XDHZZ		4041	00781		EA	
19	12	PAHZZ	5935-00-518-6983	DPD33JS	81349		EA	

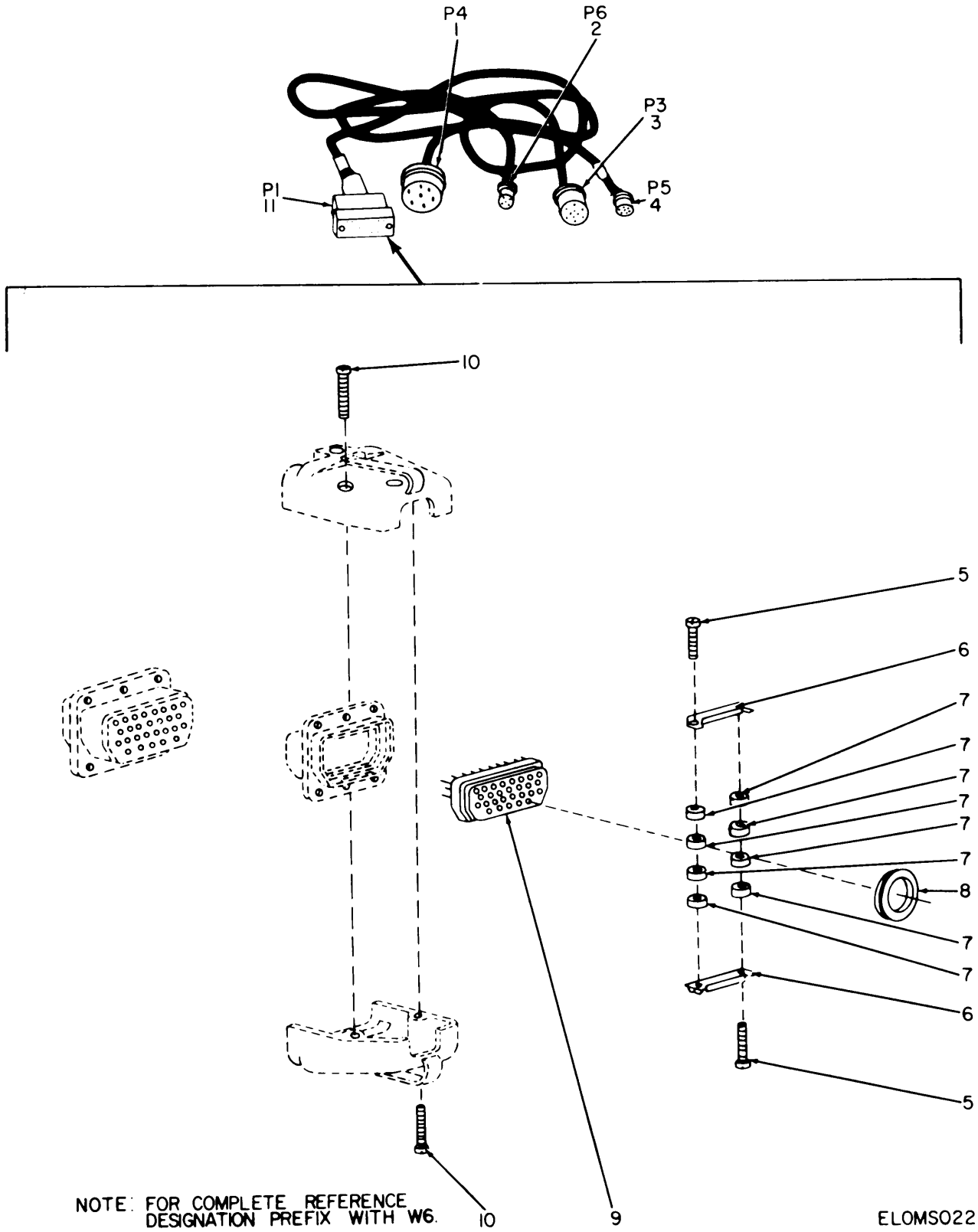

Figure 20. Wiring Harness, Branched W6.

SECTION II		TM11-6625-556-40P					
(1)	(2)	(3)	(4)	(5)	(6)	(7)	(8)
ILLUSTRATION							QTY
(A)	(B)	NATIONAL			DESCRIPTION	USABLE ON CODE	INC
FIG	ITEM	STOCK	PART	FSCM			IN
NO	NO	NUMBER	NUMBER				UNIT
					GROUP 10 WIRING HARNESS,BRANCHED W6		
20	1	PAHZZ	5935-00-683-0226	16742	00781	CONNECTOR,PLUG,ELECTRICAL	EA 1
20	2	PAHZZ	5935-00-642-2656	14491	00781	CONNECTOR,PLUG,ELECTRICAL	EA 1
20	3	XDHZZ	5935-00-549-4212	16115	00781	CONNECTOR,PLUG	EA 1
20	4	XDHZZ		19062	00781	CONNECTOR,PLUG	EA 1
20	5	XDHZZ		164-0040	00781	SCREW,MACHINE	EA 2
20	6	XDHZZ		24208	00781	CLAMP ASSEMBLY	EA 2
20	7	XDHZZ		22434	00781	INSULATOR	EA 8
20	8	XDHZZ		24241	00781	GROMMET	EA 1
20	9	XDHZZ		94-42530-2	00781	CONNECTOR,RECEPTACLE	EA 1
20	10	XDHZZ		166-0048	00781	SCREW,MACHINE	EA 2
20	11	PAHZZ	5935-00-937-4154	29434-1000	00781	CONNECTOR ASSEMBLY	EA 1

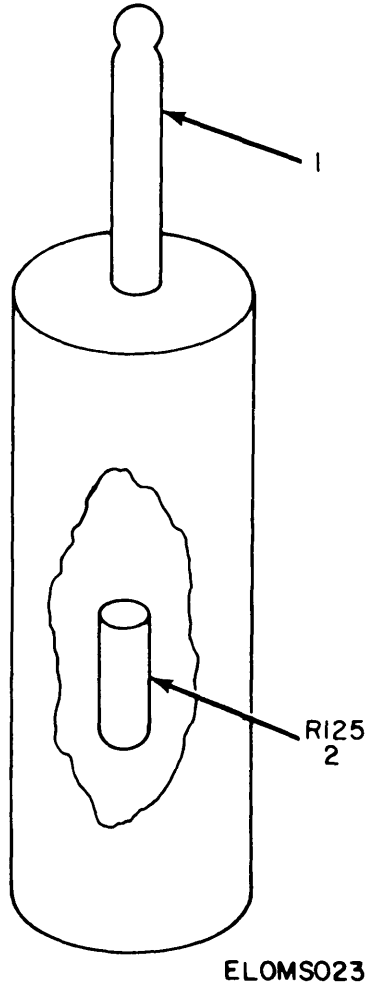
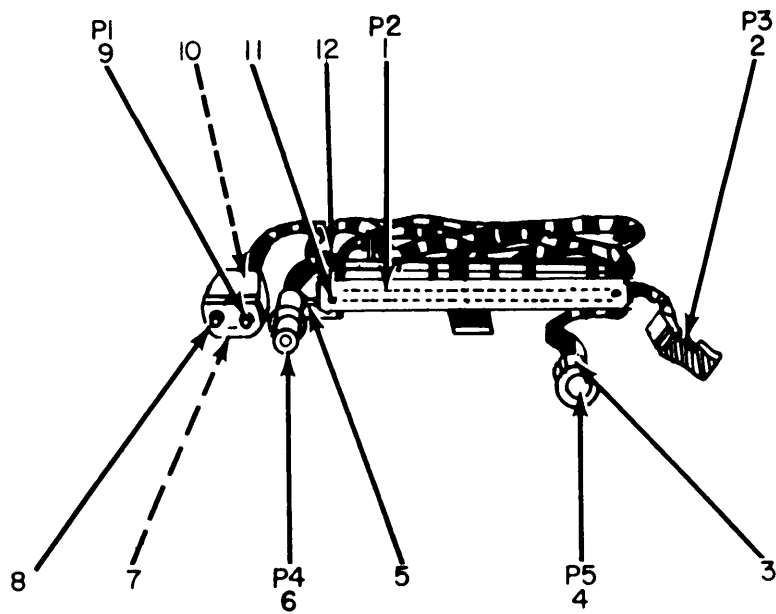

Figure 21. Tip Plug Assembly.

SECTION II		TM11-6625-556-40P						
(1)	(2)	(3)	(4)	(5)	(6)	(7)	(8)	
ILLUSTRATION					DESCRIPTION		QTY	
(A)	(B)	NATIONAL	PART	FSCM		USABLE ON CODE	INC	
FIG	ITEM	STOCK	NUMBER				IN	
NO	NO	NUMBER	NUMBER				UNIT	
					GROUP 11 TIP PLUG ASSEMBLY			
21	1	PAHZZ	5935-00-192-4760	JAN-P-642	81349 PLUG,TIP	EA	1	
21	2	PAHZZ	5905-00-811-0674	CB1511	81349 RESISTOR, FIXED, COMPOSITION	EA	1	



NOTE: FOR COMPLETE REFERENCE DESIGNATION  
PREFIX WITH W7.

ELOMS024

Figure 22. Wiring Harness, Branched W7.



SECTION II		TM11-6625-556-40P					
(1)	(2)	(3)	(4)	(5)	(6)	(7)	(8)
ILLUSTRATION							
(A)	(B)	NATIONAL			DESCRIPTION		QTY
FIG	ITEM	STOCK	PART	FSCM		USABLE ON CODE	INC
NO	NO	NUMBER	NUMBER				IN
							UNIT
					GROUP 12 WIRING HARNESS,BRANCHED W7		
22	1	PAHZZ	5935-00-933-8062	35347	00781		EA 1
22	2	XDHZZ		29747-0034	00781		EA 1
22	3	PAHZZ	5935-00-688-4026	MS3057-8A	96906		EA 1
22	4	XDHZZ		MS3107A16S1S	96906		EA 1
22	5	PAHZZ	5935-00-280-2195	MS3057-6A	96906		EA 1
22	6	PAHZZ	5935-00-811-2205	MS107A14S6S	96906		EA 1
22	7	XDHZZ		22434	00781		EA 8
22	8	XDHZZ		164-0040	00781		EA 2
22	9	PAHZZ	5935-00-937-4154	29434-1000	00781		EA 1
22	10	XDHZZ		24241	00781		EA 1
22	11	XDHZZ		166-0048	00781		EA 2
22	12	XDHZZ		24208	00781		EA 2

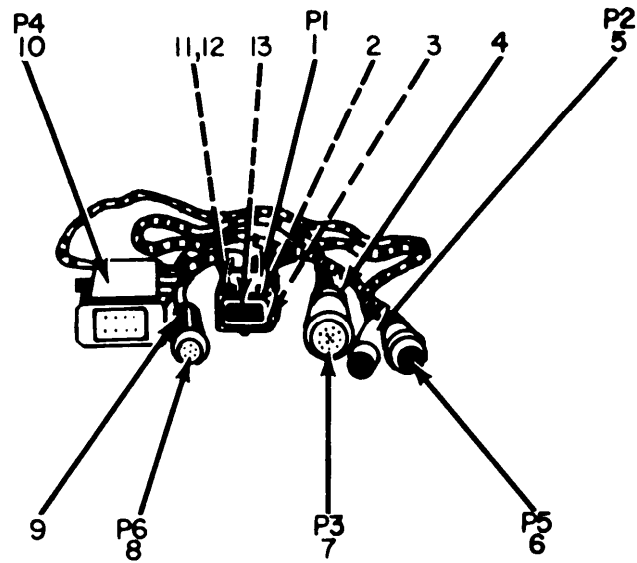

NOTE: FOR COMPLETE REFERENCE  
DESIGNATION PREFIX WITH W8. ELOMS025

Figure 23. Wiring Harness, Branched W8.

SECTION II		TM11-6625-556-40P					
(1)	(2)	(3)	(4)	(5)	(6)	(7)	(8)
ILLUSTRATION							QTY
(A)	(B)	NATIONAL			DESCRIPTION	USABLE ON CODE	INC
FIG	ITEM	STOCK	PART	FSCM			IN
NO	NO	NUMBER	NUMBER				UNIT
					GROUP 13 WIRING HARNESS,BRANCHED W8		
23	1	PAHZZ	5935-00-937-4154	29434-1000	00781	CONNECTOR ASSEMBLY	EA 1
23	2	XDHZZ		22434	00781	INSULATOR	EA 8
23	3	XDHZZ		164-0040	00781	SCREW,MACHINE	EA 2
23	4	PAHZZ	5935-00-223-0572	MS3057-12A	96906	CLAMP,CABLE	EA 1
23	5	PAHZZ	5935-00-682-0338	MS3107A20-16S	96906	CONNECTOR,PLUG	EA 1
23	6	PAHZZ	5935-00-811-2205	MS107A14S6S	96906	CONNECTOR,PLUG	EA 1
23	7	PAHZZ	5935-00-665-4690	MS3107A20-27P	96906	CONNECTOR,PLUG	EA 1
23	8	XDHZZ		35374	00781	CONNECTOR,PLUG	EA 1
23	9	PAHZZ	5935-00-688-4026	MS3057-8A	96906	CLAMP,CABLE	EA 1
23	10	PAHZZ	5935-00-937-4148	35387	00781	CONNECTOR,PLUG,ELECTRICAL	EA 1
23	11	XDHZZ		24241	00781	GROMMET	EA 1
23	12	XDHZZ		166-0048	00781	SCREW,MACHINE	EA 2
23	13	XDHZZ		24208	00781	CLAMP ASSEMBLY	EA 2

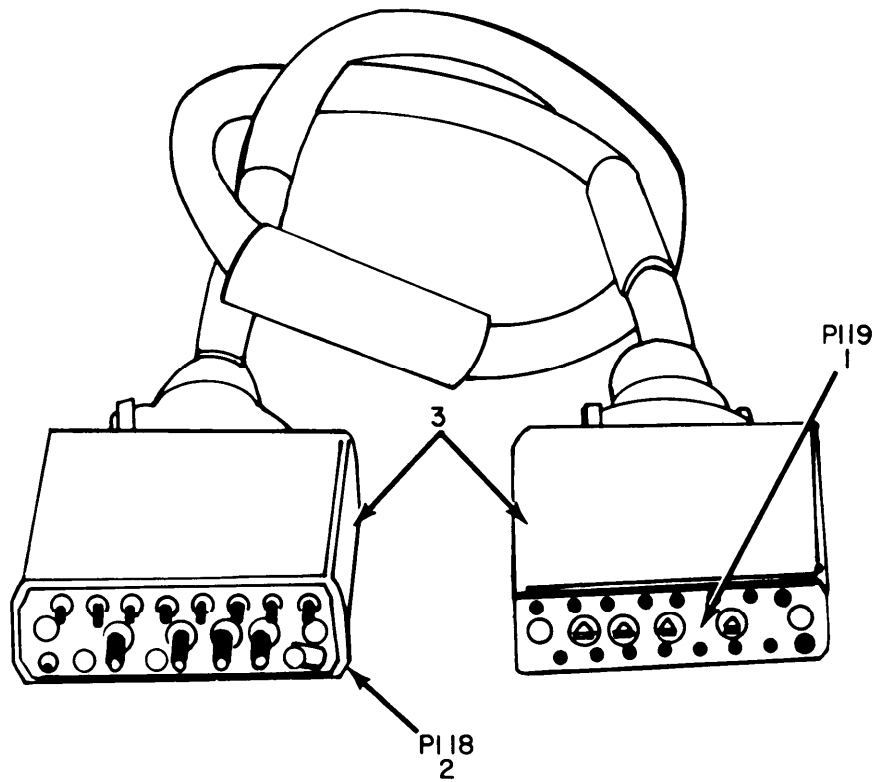

NOTE: FOR COMPLETE REFERENCE DESIGNATION  
PREFIX WITH W9.

ELOMS026

Figure 24. Cable Assembly W9.

SECTION II					TM11-6625-556-40P			
(1)	(2)	(3)	(4)	(5)	(6)	(7)	(8)	
ILLUSTRATION							QTY	
(A)	(B)	NATIONAL			DESCRIPTION		INC	
FIG	ITEM	STOCK	PART	FSCM		USABLE ON CODE	IN	
NO	NO	NUMBER	NUMBER				UNIT	
					GROUP 14 CABLE ASSEMBLY W9			
24	1	PAHZZ 5935-00-189-6245	126-150	02660	CONNECTOR, PLUG	EA	1	
24	2	PAHZZ 5935-00-295-5006	126-151	02660	CONNECTOR, PLUG	EA	1	
24	3	PAHZZ 5935-00-283-7076	126-932	02660	SHELL, CONNECTOR	EA	2	

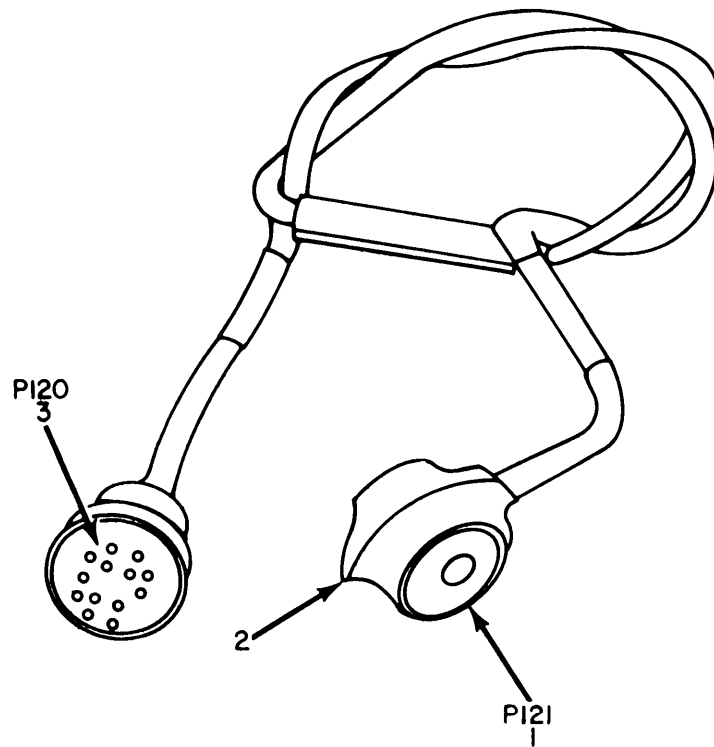

NOTE: FOR COMPLETE REFERENCE DESIGNATIONS  
PREFIX WITH W10.

ELOMS027

Figure 25. Cable Assembly W10.

SECTION II		TM11-6625-556-40P					
(1)	(2)	(3)	(4)	(5)	(6)	(7)	(8)
ILLUSTRATION							QTY
(A)	(B)	NATIONAL			DESCRIPTION		INC
FIG	ITEM	STOCK	PART	FSCM		USABLE ON CODE	IN
NO	NO	NUMBER	NUMBER				UNIT
					GROUP 15 CABLE ASSEMBLY W10		
25	1	XDHZZ		78-7P	02660	CONNECTOR, PLUG, ELECTRICAL	EA 1
25	2	XDHZZ		3-145	02660	CAP, RUBBER	EA 1
25	3	PAHZZ	5935-00-813-2704	86-895	02660	CONNECTOR, PLUG	EA 1

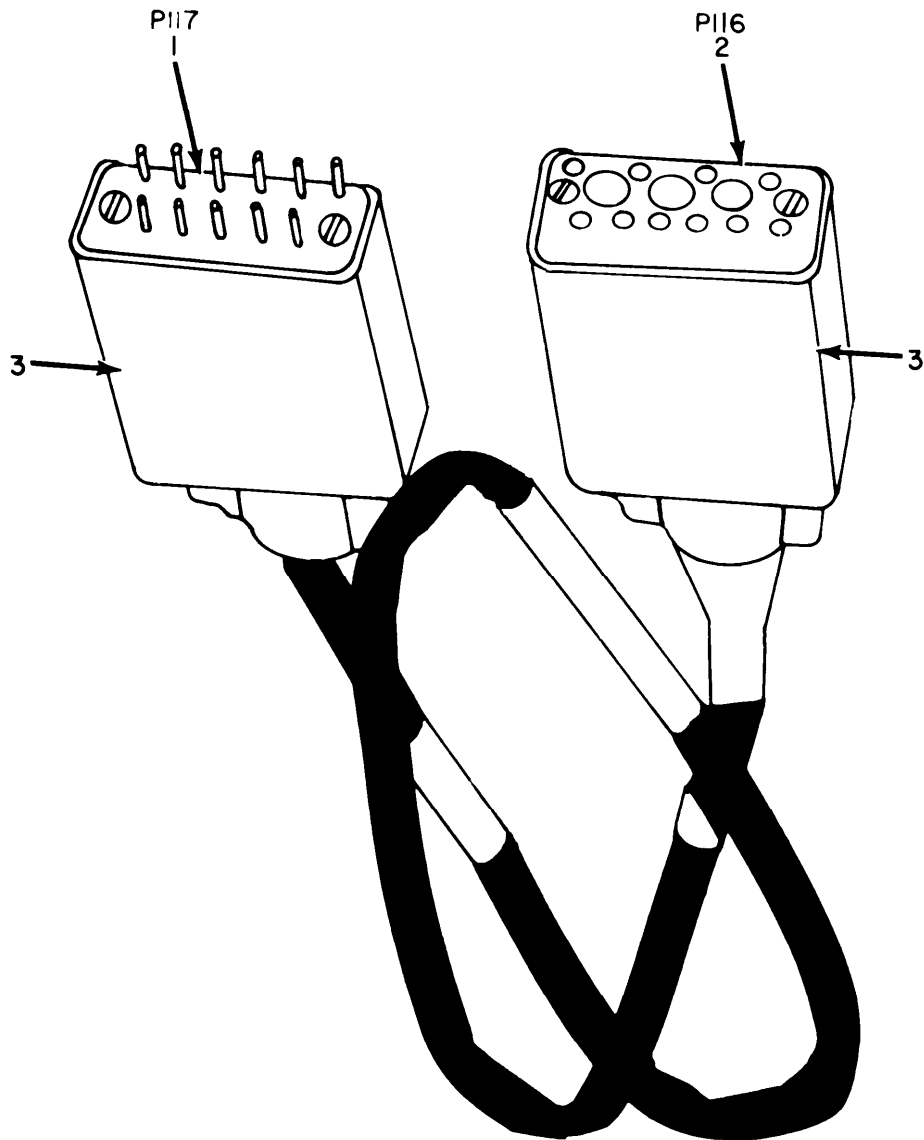

NOTE: FOR COMPLETE REFERENCE DESIGNATION  
PREFIX WITH W11.

Figure 26. Cable Assembly W11.



SECTION II		TM11-6625-556-40P					
(1)	(2)	(3)	(4)	(5)	(6)	(7)	(8)
ILLUSTRATION							QTY
(A)	(B)	NATIONAL			DESCRIPTION		INC
FIG	ITEM	STOCK	PART	FSCM		USABLE ON CODE	IN
NO	NO	NUMBER	NUMBER				UNIT
		SMR					
		CODE					
					GROUP 16 CABLE ASSEMBLY W11		
26	1	PAHZZ	5935-00-258-8572	126-807	02660	CONNECTOR, PLUG, ELECTRICAL	EA 1
26	2	PAHZZ	5935-00-626-3620	126-806	02660	CONNECTOR, PLUG, ELECTRICAL	EA 1
26	3	PAHZZ	5935-00-501-8742	126-954	02660	SHELL ASSEMBLY	EA 2

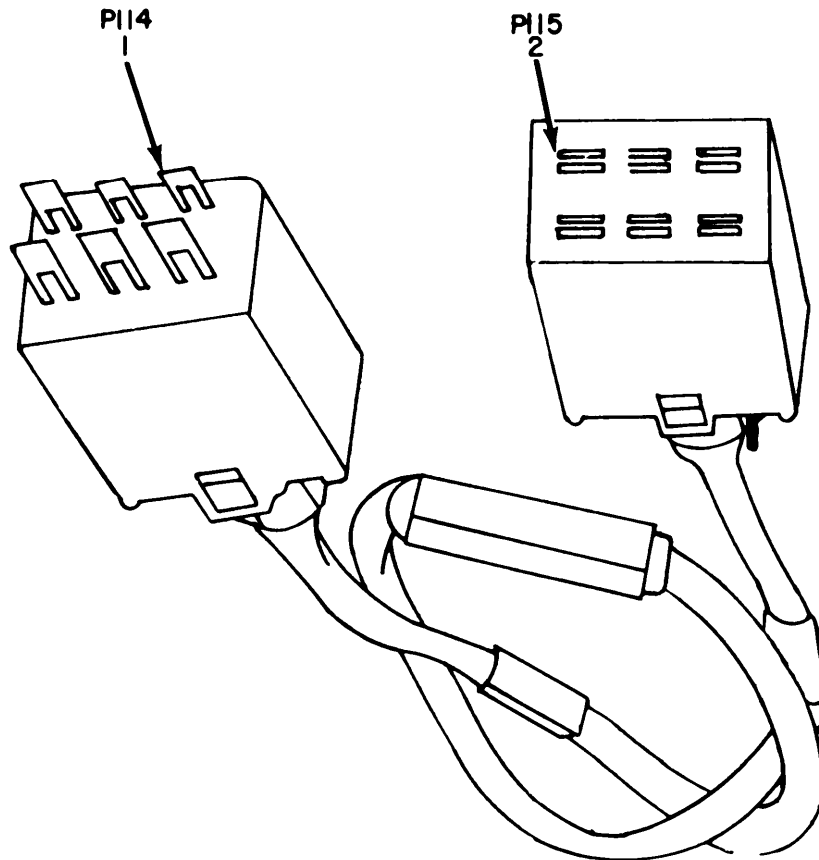

NOTE: FOR COMPLETE REFERENCE  
DESIGNATIONS PREFIX WITH W12.

ELOMS029

Figure 27. Cable Assembly W12.

SECTION II		TM11-6625-556-40P						
(1)	(2)	(3)	(4)	(5)	(6)	(7)	(8)	
ILLUSTRATION					DESCRIPTION		QTY	
(A)	(B)	NATIONAL					INC	
FIG	ITEM	STOCK	PART	FSCM		USABLE ON CODE	IN	
NO	NO	NUMBER	NUMBER				UNIT	
					GROUP 17 CABLE ASSEMBLY W12			
27	1	PAHZZ	5935-00-149-2682	P406CCT	71785	CONNECTOR, PLUG	EA 1	
27	2	PAHZZ	5935-00-149-0494	S406CCT	71785	CONNECTOR, PLUG	EA 1	

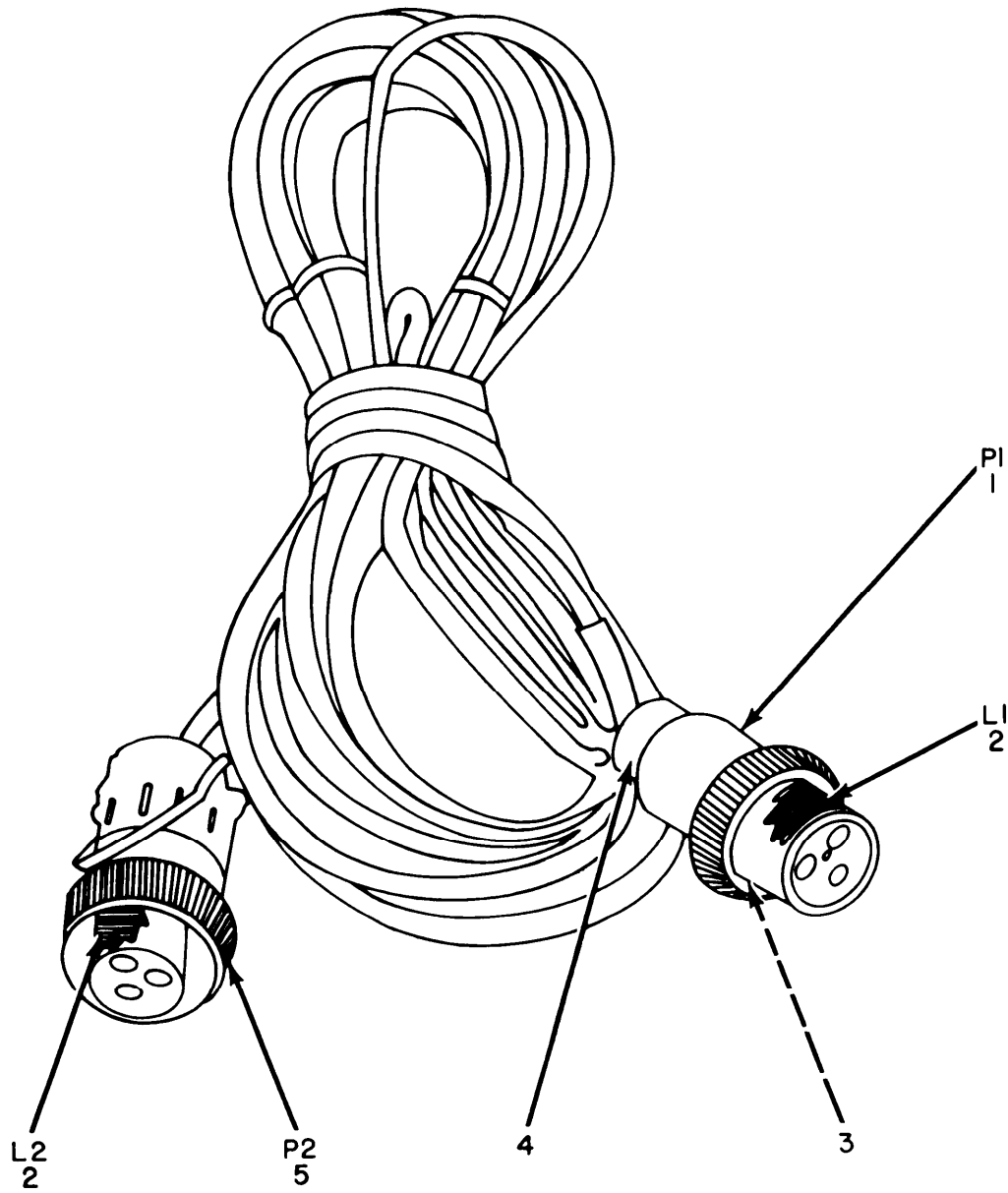

NOTE: FOR COMPLETE REFERENCE DESIGNATION  
PREFIX WITH W13.

ELOMS030

Figure 28. Cable Assembly W13.

SECTION II (1) ILLUSTRATION (A) (B) FIG ITEM NO NO		(2) SMR CODE	(3) NATIONAL STOCK NUMBER	(4) PART NUMBER	(5) FSCM	TM11-6625-556-40P (6) DESCRIPTION	(7) USABLE ON CODE	(8) QTY INC IN UNIT
						GROUP 18 CABLE ASSEMBLY W13		
28	1	PAHZZ	5935-00-937-7988	23609	00781	CONNECTOR, PLUG	EA	1
28	2	PAHZZ	5950-00-764-9764	MS16225-6	96906	CHOKE, COIL	EA	2
28	3	XDHZZ		7736	00781	TERMINAL	EA	1
28	4	XDHZZ		18729	00781	BUSHING	EA	1
28	5	PAHZZ	5935-00-148-9378	AN3106A14S7S	88044	CONNECTOR, PLUG	EA	1

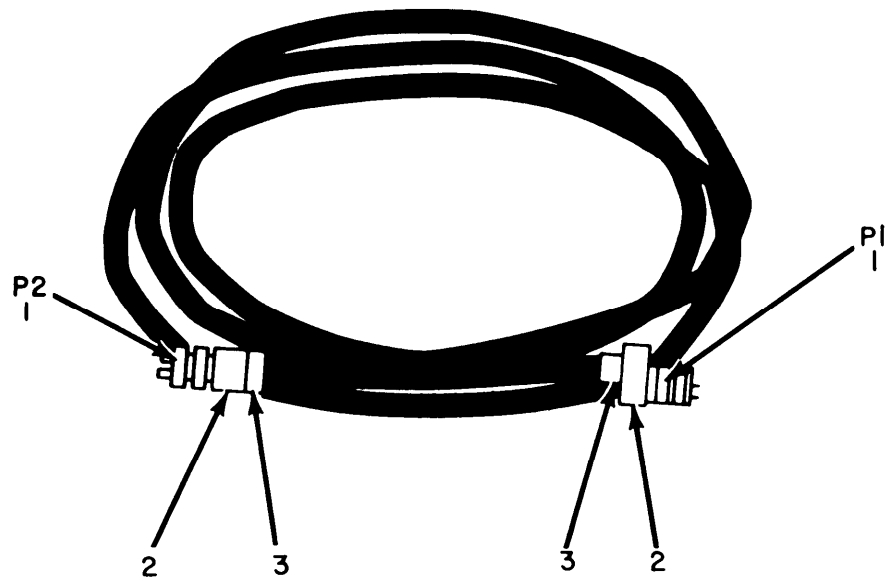

NOTE: FOR COMPLETE REFERENCE DESIGNATIONS  
PREFIX WITH W14.

ELOMS031

Figure 29. Cable Assembly, RF W14.

SECTION II		TM11-6625-556-40P						
(1)	(2)	(3)	(4)	(5)	(6)	(7)	(8)	
ILLUSTRATION							QTY	
(A)	(B)	NATIONAL			DESCRIPTION		INC	
FIG	ITEM	STOCK	PART	FSCM		USABLE ON CODE	IN	
NO	NO	NUMBER	NUMBER				UNIT	
					GROUP 19 CABLE ASSEMBLY,RADIO FREQUENCY			
					W14			
29	1	PAHZZ	5935-00-539-2651	MS3106A10SL4S	96906 CONNECTOR, PLUG	EA	2	
29	2	XDHZZ		MS3111-2	96906 RING	EA	2	
29	3	PAHZZ	5935-00-240-0173	AN3057-4	88044 CLAMP	EA	2	

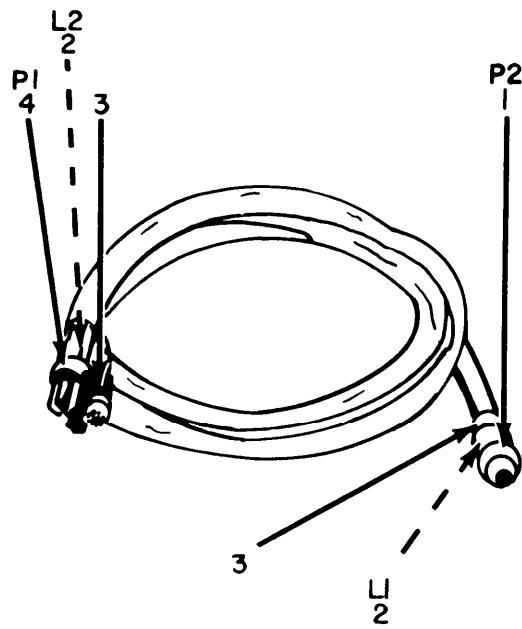

NOTE: FOR COMPLETE REFERENCE  
DESIGNATION PREFIX WITH W15.

ELOMS032

Figure 30. Cable Assembly W15.



SECTION II		TM11-6625-556-40P						
(1)	(2)	(3)	(4)	(5)	(6)	(7)	(8)	
ILLUSTRATION							QTY	
(A)	(B)	NATIONAL			DESCRIPTION		INC	
FIG	ITEM	STOCK	PART	FSCM		USABLE ON CODE	IN	
NO	NO	NUMBER	NUMBER				UNIT	
					GROUP 20 CABLE ASSEMBLY W15			
30	1	PAHZZ 5935-00-244-9919	MS3106A14S1S	96906	CONNECTOR, PLUG	EA	1	
30	2	PAHZZ 5950-00-734-3940	MS16225-7	96906	CHOKE, COIL	EA	2	
30	3	XDHZZ 36233		00781	CLAMP	EA	2	
30	4	PAHZZ 5935-00-644-7386	MS3108B14S1S	96906	CONNECTOR, PLUG	EA	1	

NOTE: LATEST NATIONAL STOCK NUMBER AND PART NUMBER ASSIGNMENTS ARE INCLUDED AT END OF INDEX.

STOCK NUMBER	FIGURE NO	ITEM NO	STOCK NUMBER	FIGURE NO	ITEM NO
5905-00-078-8763	10	13	5935-00-644-7386	30	4
5935-00-148-9378	28	5	5930-00-655-1508	12	13
5935-00-149-0494	27	2	5930-00-655-1514	3	8
5935-00-149-2682	27	1	5930-00-655-1575	3	25
5935-00-149-3534	1	4	5930-00-658-3867	3	21
6240-00-155-7836	3	4	5935-00-665-4690	23	7
5935-00-189-6245	24	1	5930-00-669-7326	3	6
5905-00-190-8887	8	2	5826-00-681-9878	1	12
5935-00-192-4729	3	47	5935-00-682-0338	23	5
5935-00-192-4760	21	1	5930-00-685-9521	3	32
5935-00-201-2408	1	7	5935-00-685-9885	17	3
5935-00-201-2469	12	2	5935-00-688-4026	22	3
5935-00-201-3090	1	5	5935-00-688-4026	23	9
5935-00-201-3511	3	57	5826-00-697-9880	3	2
5935-00-201-3511	10	26	6240-00-723-3378	3	41
5935-00-223-0572	23	4	5910-00-726-2448	12	6
5945-00-238-7927	10	10	5910-00-754-7081	10	23
5935-00-244-9919	30	1	5970-00-755-4297	2	38
5935-00-257-8311	3	1	5905-00-792-1581	10	20
5935-00-257-9735	13	3	5905-00-811-0674	21	2
5935-00-258-8572	26	1	5935-00-811-2205	22	6
5905-00-259-2800	3	12	5935-00-811-2205	23	6
5905-00-279-1894	3	18	5935-00-813-2704	25	3
5905-00-279-2545	3	48	5935-00-823-0487	8	5
5905-00-279-2557	10	8	5930-00-823-0856	3	23
5905-00-279-2616	3	52	5930-00-823-0857	3	24
5935-00-280-2195	22	5	5995-00-832-5227	1	21
5935-00-280-2353	16	4	5995-00-832-5228	1	29
5935-00-283-3826	2	32	5925-00-842-7299	3	42
5935-00-283-7076	24	3	5935-00-846-8101	16	5
5935-00-295-4803	3	5			
5935-00-295-5006	24	2	5961-00-853-2607	8	6
5935-00-295-5437	17	1	5935-00-859-2641	15	8
5935-00-295-5438	15	7	5355-00-863-3783	2	27
5935-00-295-5438	17	16	5826-00-875-6446	6	1
5935-00-295-5440	17	15	5910-00-880-4509	10	33
5930-00-296-5782	3	31	5905-00-884-1527	10	7
5910-00-392-5931	10	25	6210-00-892-4431	2	1
5830-00-496-9646	2	21	6210-00-892-4433	2	3
5940-00-500-8717	2	39	6210-00-892-4434	2	4
5935-00-501-8742	26	3	6210-00-892-4437	2	7
5935-00-511-8455	7	1	6210-00-892-4438	2	8
5935-00-513-2373	19	1	6210-00-892-4439	2	9
5940-00-518-7648	10	2	6210-00-892-4440	2	10
5821-00-524-6627	2	35	6210-00-892-4441	2	11
5915-00-536-3370	10	28	6210-00-892-4442	2	12
5935-00-539-4282	9	1	6210-00-892-4443	2	13
5935-00-542-8182	13	8	6210-00-892-4445	2	15
5935-00-542-8182	15	5	5930-00-916-7857	3	27
5905-00-542-9790	12	12	6625-00-926-7771	10	3
5940-00-549-1072	10	22	6625-00-931-6821	3	51
5935-00-549-3834	17	2	6625-00-931-6823	10	6
5935-00-549-3835	17	4	6625-00-931-6825	3	39
5935-00-549-4212	15	6	5905-00-933-6334	3	26
5935-00-549-4212	17	14	5910-00-933-6371	12	8
5935-00-549-4212	20	3	5910-00-933-6372	12	7
5935-00-552-2670	16	1	5995-00-933-6906	1	20
6625-00-555-4385	3	38	5995-00-933-6908	1	19
5930-00-556-9530	13	1	5995-00-933-6910	1	25
5935-00-577-2337	2	31			
6210-00-577-8146	2	42			
5905-00-581-1010	12	10	5995-00-933-7436	1	14
5905-00-581-4980	12	11			
5930-00-583-6959	3	35	5945-00-933-7485	10	31
5905-00-583-8183	3	33	5355-00-933-7740	2	22
5930-00-583-8260	3	37	5355-00-933-7741	2	29
5905-00-586-9580	10	11			
5905-00-586-9671	10	16	5355-00-933-7743	2	34
5905-00-586-9823	10	17	5995-00-933-7758	1	22
5905-00-587-0707	10	14	5935-00-933-8062	22	1
5120-00-590-8030	1	10	5905-00-933-8494	10	19
5310-00-616-3555	19	10	6625-00-933-8598	3	28
6210-00-617-1552	2	43	6210-00-933-8652	2	41
5935-00-626-3620	26	2	6625-00-935-6917	1	24
5945-00-630-4888	3	9	5935-00-937-0833	2	23
5935-00-630-5442	17	13	6625-00-937-4033	1	8
5935-00-633-6246	18	3	6625-00-937-4034	1	11
5930-00-636-4735	3	22	5935-00-937-4139	15	9
5935-00-642-2656	20	2	5935-00-937-4148	23	10
5935-00-644-6750	10	34	5935-00-937-4150	15	2

STOCK NUMBER	FIGURE NO	ITEM NO	STOCK NUMBER	FIGURE NO	ITEM NO		
5935-00-937-4151	15	1	5905-00-954-5581	10	18		
5935-00-937-4152	18	1	6625-00-974-6439	16	2		
5935-00-937-4153	19	2	6625-00-974-6439	17	12		
5935-00-937-4154	20	11	6625-00-974-6442	1	23		
5935-00-937-4154	22	9	5999-00-978-7453	10	27		
5935-00-937-4154	23	1	5930-00-982-0345	12	1		
5935-00-937-4908	2	30	5930-00-982-0346	3	3		
			5910-00-982-0401	12	5		
PART NUMBER	FSCM	FIG NO	ITEM NO	PART NUMBER	FSCM	FIG NO	ITEM NO
AN3057-4	88044	29	3	MS35043-87	96906	10	21
AN3106A14S7S	88044	28	5	MS35043-94	96906	8	2
AN3420-8	81350	3	44	MS35044-64	96906	10	8
C-1827/ARC-55	80058	3	14	MS35058-22	96906	3	8
CB1511	81349	21	2	MS35058-23	96906	3	17
CC30UJ101J	81349	8	3	MS35059-22	96906	3	25
CC30UJ11J	81349	12	5	MS35059-30	96906	3	32
CDIR-235	01295	10	18	NE2J	08806	3	41
CDIR-295	01295	10	19	PA2039	25244	3	3
CDIR-614	01295	10	13	P406CCT	71785	27	1
CDIR-901	01295	3	30	RFN0756	00781	1	8
CD1/2PR-135	01295	10	11	RN70B1101F	81349	12	12
CD1/2PR-163	01295	10	20	RN70B1741F	81349	12	11
CD1/2PR-204	01295	10	15	RN70B6810F	81349	12	10
CD1/2PR-271	01295	10	12	SM-295/ARM-63	80058	1	3
CD1/2PR-514	01295	10	17	S406CCT	71785	27	2
CD1/2PR-593	01295	10	16	TC20A	71590	12	6
CD1/2PRM33.2K	01295	10	14	TC25	71590	12	4
CD1/2PR30	01295	10	7	TF4SX02FA	80058	10	35
CE32C250J	81349	10	30	TS-1797/ARM-63	80058	1	1
DM-19-511	02799	3	56	UG-201/U	81349	1	5
DPD32-335-IL	71468	19	1	UG-273/U	81349	1	4
DPD33JS	81349	19	12	UG-88/U	81349	8	5
D30913	00781	10	33	UG-88/U	81349	9	2
FGC-C2-95	26428	3	26	UG-88/U	81349	11	1
GB-3015	01121	3	48	UG291/U	81349	9	1
				VM911M10	72619	2	41
ID-250A/ARN	80058	3	46	1N295	81349	8	6
JAN-P-642	81349	16	6	10021	00781	2	21
JAN-P-642	81349	12	1	101-5030-931	72619	2	18
				101-5030-932	72619	2	43
JJSA-1041-B5031-FS2032	01121	3	33	101-5030-933	72619	2	42
JS-5021J	01121	3	7	101300PIC	76854	3	23
JSB5031-FS2032	01121	3	12	101301PIC	76854	3	24
K03-21-30-SN	71468	3	15	10307-0002	94375	1	10
K06-21-5/8	71468	3	16	105-602	74970	2	33
MM5-11-5/16	71468	18	3	105-603	74970	2	32
MRE9S-UTC6H	81312	18	2	105-604	74970	2	31
MS107A14S6S	96906	22	6	110D205X0150C0	56289	10	9
MS107A14S6S	96906	23	6	12348	00781	13	5
MS16225-6	96906	28	2	126-150	02660	24	1
MS16225-7	96906	30	2	126-151	02660	24	2
MS24509-35	96906	3	42	126-806	02660	26	2
MS24509-5	96906	3	40	126-807	02660	26	1
MS25100-23	96906	12	13	126-932	02660	24	3
MS3057-10A	96906	18	11	126-954	02660	26	3
MS3057-12A	96906	3	45	12713	00781	10	10
MS3057-12A	96906	23	4	13AT3	91929	3	6
MS3057-16A	96906	16	4	13025	00781	10	2
MS3057-6A	96906	22	5	13534	00781	2	26
MS3057-8A	96906	22	3	137-8864-0931-512	72619	2	20
MS3057-8A	96906	23	9	14050	00781	15	7
MS3106A14S1S	96906	30	1	14050	00781	17	16
MS3106A22-14S	96906	3	43	14051	00781	17	1
MS3106A24-5S/C/	96906	16	1	14052	00781	17	15
				14079	00781	10	22
MS3107A16S1S	96906	22	4	14320	00781	3	1
MS3107A20-16S	96906	23	5	14485	00781	10	32
MS3107A20-27P	96906	23	7	14491	00781	20	2
MS3108A18-9S	96906	18	10	146-0032	00781	19	9
MS3108B14S1S	96906	30	4	14747	00781	12	2
MS3108B24-7S/C1/	96906	16	5	1489	25244	3	22
MS3111-2	96906	29	2	150D10CX0035R2	56289	10	23
MS35043-115	96906	3	52	153-0020	00781	13	11
MS35043-127	96906	8	7	15535	00781	10	25
MS35043-61	96906	3	18	15834	00781	13	8
MS35043-63	96906	10	5	15834	00781	15	5

PART NUMBER	FSCM	FIG NO	ITEM NO	PART NUMBER	FSCM	FIG NO	ITEM NO
16115	00781	17	14	23739	00781	10	26
16115	00781	20	3	23759	00781	8	4
16115	02660	15	6	23771	00781	8	1
16158-0014	00781	3	13	23831	00781	5	1
16158-0017	00781	3	36	23852	00781	4	1
16158-0048	00781	1	23	24C	76545	14	1
16331-0000	00781	2	22				
164-0040	00781	15	4	24208	00781	15	3
164-0040	00781	18	4	24208	00781	18	5
164-0040	00781	19	3	24208	00781	19	4
164-0040	00781	20	5	24208	00781	20	6
164-0040	00781	22	8	24208	00781	22	12
164-0040	00781	23	3	24208	00781	23	13
164-0044	00781	15	10	24240	00781	15	12
164-0044	00781	16	7	24240	00781	16	10
164-0044	00781	17	6	24240	00781	17	9
165-0048	00781	18	9	24241	00781	18	7
166-0048	00781	19	8	24241	00781	19	6
166-0048	00781	20	10	24241	00781	20	8
166-0048	00781	22	11	24241	00781	22	10
166-0048	00781	23	12	24241	00781	23	11
166-0100	00781	15	11	24539	00781	16	8
166-0100	00781	16	12	24539	00781	17	7
166-0100	00781	17	11	24546	00781	2	40
16706	00781	3	2	24547	00781	2	29
16711	00781	7	1	24966-0028	00781	10	31
16742	00781	20	1	2500003-01651U2JU360J	72982	12	8
16743	00781	17	4	25305-XXXX	00781	7	2
16744	00781	17	2	28702	00781	10	29
16798	00781	10	28	29418	00781	1	18
16985	00781	2	35	29419	00781	1	14
1703	78189	13	10				
1706	78189	19	10				
17074	00781	3	9				
18428	00781	3	38				
18729	00781	28	4				
18730	00781	17	3				
18740	00781	17	13	29431-0001	00781	1	2
18802	04781	1	6	29432	00781	3	51
19062	00781	20	4	29433	00781	15	2
19237	00781	17	5	29434-1000	00781	20	11
19982	00781	3	35	29434-1000	00781	22	9
20403	00781	2	27	29434-1000	00781	23	1
20452	00781	3	37	29434-2000	00781	18	1
20562-0000	00781	2	37	29434-3000	00781	19	2
20789	00781	13	12	29434-4000	00781	15	1
21241	00781	3	10	2966	07239	3	28
21330	00781	1	11	29747-0034	00781	22	2
21860-0101	00781	2	1	3-145	02660	25	2
21860-0102	00781	2	2				
21860-0103	00781	2	3				
21860-0104	00781	2	4	30073	00781	1	19
21860-0105	00781	2	5	30074	00781	1	25
21860-0108	00781	2	6	30075	00781	1	22
21860-0109	00781	2	7	30076	00781	1	21
21860-0110	00781	2	8	30077	00781	1	29
21860-0111	00781	2	9	30134	00781	1	7
21860-0112	00781	2	10	327	08806	3	4
21860-0114	00781	2	11	35226	00781	10	24
21860-0115	00781	2	12	35252-0001	00781	3	11
21860-0116	00781	2	13	35252-0002	00781	3	19
21860-0117	00781	2	14	35260	00781	12	3
21860-0118	00781	2	15	35262	00781	3	39
22044	00781	13	9	35276	00781	2	36
22045	00781	13	2	35278	00781	10	4
22048	00781	1	12	35279	00781	2	34
22390-XXXX	00781	13	4	35284	00781	3	20
22434	00781	16	9	35291	00781	3	34
22434	00781	17	8	35297	00781	2	19
22434	00781	18	6	35305	00781	2	28
22434	00781	19	5	35310	00781	2	17
22434	00781	20	7	35311	00781	1	28
22434	00781	22	7	35312	00781	3	54
22434	00781	23	2	35316	00781	3	29
22448	00781	15	8	35324	00781	3	55
23AT3	91929	13	1	35345-1000	00781	15	9
23589	00781	15	2	35345-2000	00781	16	2
23609	00781	28	1	35345-2000	00781	17	12
23727	00781	6	1	35347	00781	22	1
23734	00781	5	3	35355-0005	00781	10	6

NOTE: LATEST NATIONAL STOCK NUMBER AND PART NUMBER ASSIGNMENTS ARE INCLUDED AT END OF INDEX.

PART NUMBER	FSCM	FIG NO	ITEM NO	PART NUMBER	FSCM	FIG NO	ITEM NO
35355-0030	00781	10	3	8AG1/32	75915	3	49
35374	00781	23	8	801000X5F102K	72982	12	7
35387	00781	23	10	8081	00781	13	7
35388-2004	81349	16	3	86-895	02660	25	3
36233	00781	30	3	87000	30684	3	57
3991217-A	76854	12	1	87000	30684	12	9
3996134	76854	3	27	938C	24655	2	39
4041	00781	19	11	938D	24655	2	16
4749	00781	3	5	938YB	24655	2	38
503-0016	00781	13	6	94-377	02660	2	23
54000	94375	10	27	94-381	02660	2	30
5488	00781	13	3	94-42530-2	00781	18	8
70378-MF4	76854	3	21	94-42530-2	00781	19	7
7086	00781	1	9	94-42530-2	00781	20	9
7427	72268	14	2	94-466	02660	2	25
7467	00781	10	34	94-467	02660	2	24
7665K4	27192	3	31	94-65940-2	00781	16	11
7736	00781	28	3	94-65940-2	00781	17	10
78-7P	02660	25	1				

## LATEST NATIONAL STOCK NUMBER ASSIGNMENTS

STOCK NUMBER	FIG NO	ITEM NO	STOCK NUMBER	FIG NO	ITEM NO
6625-00-001-1374	3	50	5910-00-615-0105	8	3
5905-00-106-9344	10	5	6210-00-617-1551	2	18
5935-00-133-0395	2	33	5935-00-642-0979	3	16
5365-00-141-6944	3	44	5930-00-655-1515	3	17
5935-00-149-2703	16	6	5935-00-683-0226	20	1
5935-00-149-4066	9	2	5950-00-734-3940	30	2
5935-00-149-4066	11	1	5950-00-764-9764	28	2
5935-00-192-4760	1	9	5935-00-809-0786	18	11
5905-00-195-6806	10	21	5925-00-850-7244	3	40
5935-00-201-3511	12	9	6625-00-880-4832	1	27
5999-00-204-8350	14	1	6625-00-880-4833	1	13
5935-00-223-0572	3	45	6625-00-880-4834	1	15
5935-00-240-0173	29	3	6625-00-880-4835	1	26
5910-00-240-2878	12	4	6625-00-880-5081	1	17
5935-00-259-5315	13	5	3020-00-882-4037	5	2
5826-00-505-3094	3	46	5935-00-929-4864	14	2
5935-00-518-6983	19	12	5355-00-933-7739	2	26
5940-00-549-9037	2	16	6680-00-933-8015	3	36
5935-00-552-2374	3	43	6680-00-933-8479	3	13
5355-00-577-4665	1	6	6625-00-935-5189	1	16
			5935-00-937-7988	28	1

## LATEST PART NUMBER ASSIGNMENTS

PART NUMBER	FSCM	FIG. NO.	ITEM NO.
B160	88141	10	1
CX-8739/ARM-63	80058	1	24
CX-8741/ARM-63	80058	1	25
CX-8743/ARM-63	80058	1	20
CX-8744/ARM-63	80058	1	27
CX-8745/ARM-63	80058	1	26
CX-8746/ARM-63	80058	1	15
CX-8747/ARM-63	80058	1	16
CX-8748/ARM-63	80058	1	13
CX-8749/ARM-63	80058	1	17
C12B	82389	3	47
MS3106A10SL4S	96906	29	1
11369-0072	00781	3	53
56-250HS	28569	3	50

## ADDITIONAL LATEST NATIONAL STOCK NUMBER ASSIGNMENTS

STOCK NUMBER	FIG. NO.	ITEM NO.
6130-00-027-4029	10	1
5905-00-088-3104	3	30
5905-00-254-9201	8	7
5820-00-534-2787	3	14
5935-00-539-2651	29	1
5355-00-584-4300	2	37
5930-00-646-4619	3	10
5905-00-792-6616	10	12



# SOMETHING WRONG WITH THIS MANUAL?

THEN... JOT DOWN THE DOPE ABOUT IT ON THIS FORM, TEAR IT OUT, FOLD IT AND DROP IT IN THE MAIL!

FROM: (YOUR UNIT'S COMPLETE ADDRESS)

Commander  
Stateside Army Depot  
ATTN: AMSTA-US  
Stateside, N.J. 07703

DATE 10 July 1975

PUBLICATION NUMBER TM 11-5840-340-12	DATE 23 Jan 74	TITLE Radar Set AN/SPC-76
---	-------------------	------------------------------

BE EXACT... PIN-POINT WHERE IT IS				IN THIS SPACE TELL WHAT IS WRONG AND WHAT SHOULD BE DONE ABOUT IT:
PAGE NO.	PARA-GRAPH	FIGURE NO.	TABLE NO.	
2-25	2-28			<p>Recommend that the installation antenna alignment procedure be changed through to specify a 2° IFF antenna lag rather than 1°.</p> <p>REASON: Experience has shown that with only a 1° lag, the antenna servo system is too sensitive to wind gusting in excess of 25 knots, and has a tendency to rapidly accelerate and decelerate as it hunts, causing strain to the drive train. Hunting is minimized by adjusting the lag to 2° without degradation of operation.</p>
3-10	3-3		3-1	<p>Item 5, Function column. Change "2 db" to "3db."</p> <p>REASON: The adjustment procedure for the TRANS POWER FAULT indicator calls for a 3 db (500 watts) adjustment to light the TRANS POWER FAULT indicator.</p>
5-6	5-8			<p>Add new step f.1 to read, "Replace cover plate removed in step e.1, above."</p> <p>REASON: To replace the cover plate.</p>
		FO3		<p>Zone C 3. On J1-2, change "+24 VDC to "+5 VDC."</p> <p>REASON: This is the output line of the 5 VDC power supply. + 24 VDC is the input voltage.</p>

TEAR ALONG DOTTED LINE

TYPED NAME, GRADE OR TITLE, AND TELEPHONE NUMBER SSG I. M. DeSpirito 999-1776	SIGN HERE: <i>SSG I. M. DeSpirito</i>
--	--







# SOMETHING WRONG WITH THIS MANUAL?

THEN . . . JOT DOWN THE DOPE ABOUT IT ON THIS FORM. TEAR IT OUT, FOLD IT AND DROP IT IN THE MAIL!

FROM: (YOUR UNIT'S COMPLETE ADDRESS)

DATE

PUBLICATION NUMBER

DATE

TITLE

BE EXACT. . . PIN-POINT WHERE IT IS

IN THIS SPACE TELL WHAT IS WRONG AND WHAT SHOULD BE DONE ABOUT IT:

PAGE NO.	PARA-GRAPH	FIGURE NO.	TABLE NO.
----------	------------	------------	-----------

TEAR ALONG DOTTED LINE

TYPED NAME, GRADE OR TITLE, AND TELEPHONE NUMBER

SIGN HERE:

DA FORM 2028-2 (TEST)  
1 AUG 74

P.S.--IF YOUR OUTFIT WANTS TO KNOW ABOUT YOUR MANUAL "FIND" MAKE A CARBON COPY OF THIS AND GIVE IT TO YOUR HEADQUARTERS.

FILL IN YOUR  
UNIT'S ADDRESS

FOLD BACK

Commander  
US Army Electronics Command  
ATTN: DRSEL-MA-Q  
Fort Monmouth, New Jersey 07703

FOLD BACK

TEAR ALONG  
AD LINE



FILL IN YOUR  
UNIT'S ADDRESS

FOLD BACK

Commander  
US Army Electronics Command  
ATTN: DRSEL-MA-Q  
Fort Monmouth, New Jersey 07703

TEAR ALONG  
AD LINE

FOLD BACK

REVERSE OF DA FORM 2026-2 (TEST)

# SOMETHING WRONG WITH THIS MANUAL?



THEN... JOT DOWN THE DOPE ABOUT IT ON THIS FORM, TEAR IT OUT, FOLD IT AND DROP IT IN THE MAIL!

FROM: (YOUR UNIT'S COMPLETE ADDRESS)

DATE

PUBLICATION NUMBER

DATE

TITLE

BE EXACT... PIN-POINT WHERE IT IS

IN THIS SPACE TELL WHAT IS WRONG AND WHAT SHOULD BE DONE ABOUT IT:

PAGE NO.

PARA-  
GRAF#

FIGURE NO.

TABLE NO.

TEAR ALONG DOTTED LINE

TYPED NAME, GRADE OR TITLE, AND TELEPHONE NUMBER

SIGN HERE:

FILL IN YOUR  
UNIT'S ADDRESS

FOLD BACK

Commander  
US Army Electronics Command  
ATTN: DRSEL-MA-Q  
Fort Monmouth, New Jersey 07703

FOLD BACK

TEAR ALONG  
AD LINE

REVERSE OF DA FORM 2026-2 (TEST)

By Order of the Secretary of the Army:

BERNARD W. ROGERS  
*General, United States Army*  
*Chief of Staff*

Official:

PAUL T. SMITH  
*Major General, United States Army*  
*The Adjutant General*

DISTRIBUTION:

To be distributed in accordance with DA Form 12-36A, Direct and General Support maintenance requirements for AN/ARM-63.







